

Jones

pattern booklet no.9

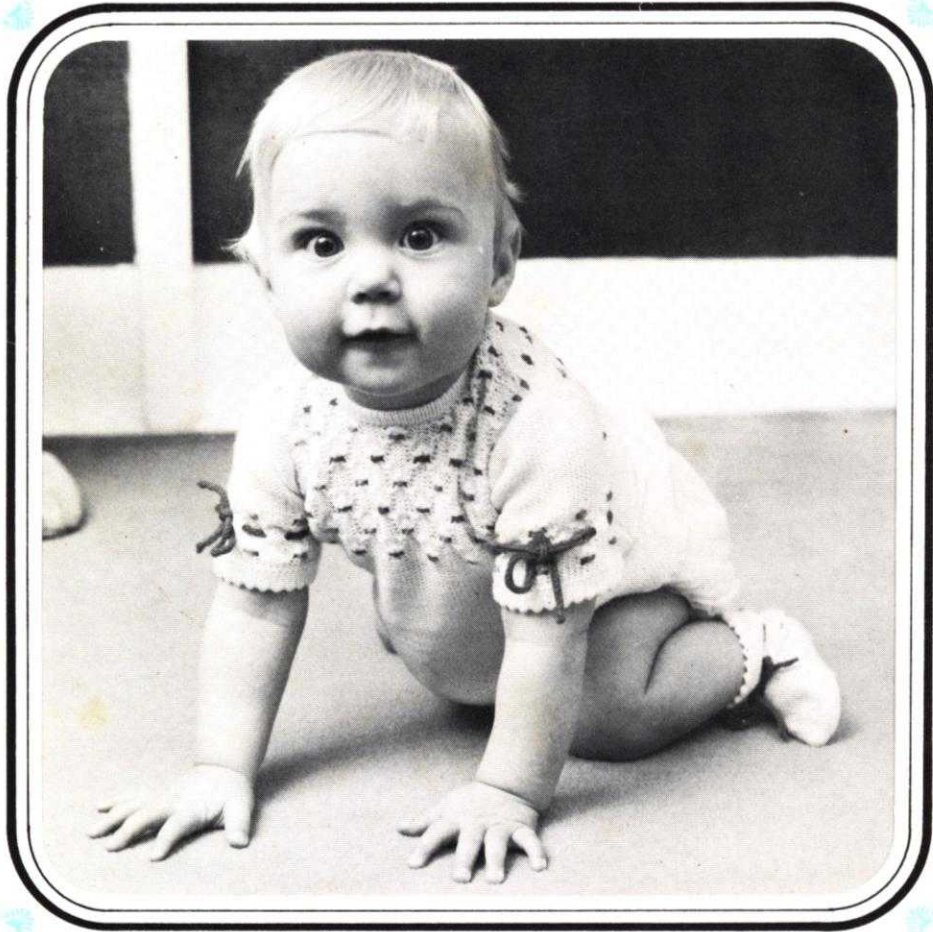

Abbreviations

M.B.	Main Bed	000	set counter at 000
st. st.	Stocking stitch	fol.	following
sts.	stitches	T.	tension
beg.	beginning	K.	Knit
dec.	decrease	M.D.E.	make double edge
inc.	increase	Ns.	needles
alt.	alternate	C.O.L. (R)	carriage on left (right)
trans.	transfer	patt.	pattern
opp.	opposite	rem.	remaining
carr.	carriage	H.C.L.	holding cam levers
S.D.	Side Dial	C.O.B.H.	cast on by hand
w.wl.	waste wool	in.	inch
m.wl.	main wool	oz.	ounce
m/c(s)	machine(s)	tub.	tubular
pos.	position	p.b.	part button

Cape, Hood and Shawl

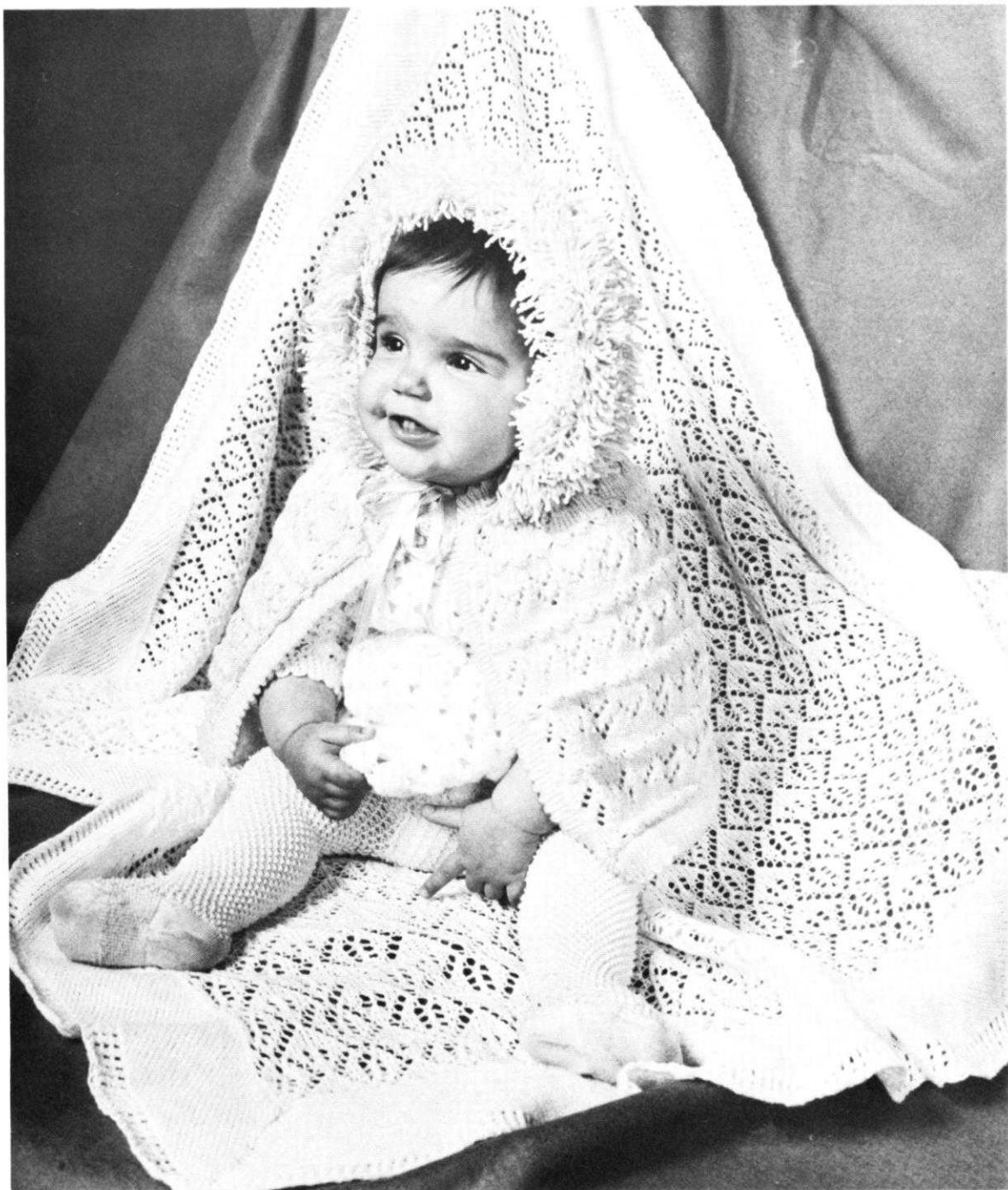

Lace and Plain Coats

↑																									24		
↓	↓	↘		0	0	0																			23		
↑																									22		
↓	↓	↘		0	0	0																			21		
↑																									20		
↓	↓	↘	0	0	0																				19		
↑																									18		
↓	↓	↘		0	0																		0		17		
↑																									16		
↓	↓	↘	0	0																		0			15		
↑																									14		
↓	↓	↘		0									0	0											13		
↑																									12		
↓	↓	↘	0											0	0										11		
↑																									10		
↓	↓	↘											0	0	0										9		
↑																									8		
↓	↓	↘											0	0	0										7		
↑																									6		
↓	↓	↘											0	0	0										5		
↑																									4		
↓	↓	↘												0	0	0									3		
↑																									2		
↓	↓	↘												0	0	0									1		
K.C.	L.C.	S.L.		1	2	3	4	5	6	7	8	9	10	11	12											STEPS	
3	2	1		K.H.800 MACHINE																							

CHART B

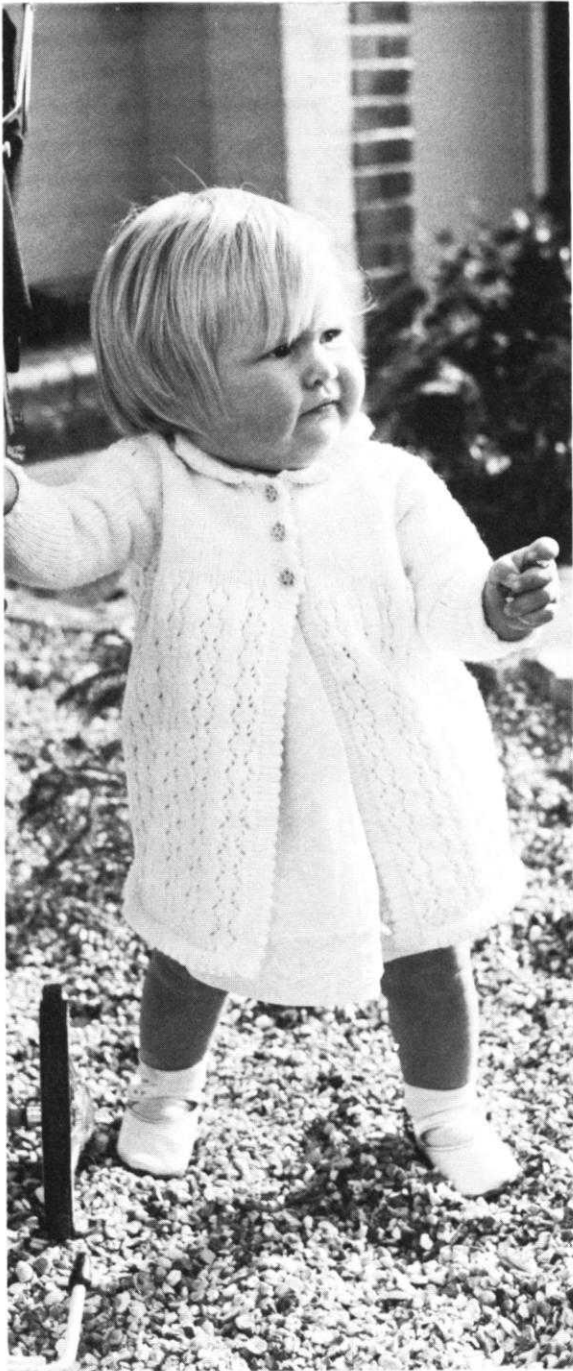



Materials

Robins Wools – Baby Quicker Knit Bri-nylon

Style 1. 9 (9, 10) ozs.

Style 2. 6 (6, 7) ozs. Colour A
4 ozs. Colour B

Measurements

To fit 18 (20, 22) in. chest

Finished measurements 19½ (21½, 23½) in. chest

Length from shoulder 13 (14½, 16) ins.

Underarm 6 (6½, 7) ins.

Tension

6½ sts. x 11 rows to 1 in. T9.

Back

1 Hem Cast on 93 (99, 105) sts. T7. K. 6 rows. T10. K. 1 row. Make picot edge by transferring every alt. st. by moving lace carr. from L. to R. T7. K. 6 rows M.D.E. T9. K. 1 row. C.O.R. 000.

For style 1 start patt. from graph. (SLIDE DIAL ON 1. Model 588).

2 92 (104, 116) rows straight.

K. a few rows with w. wl. and take off M/C. Rehang over 63 (69, 75) sts. by doubling up on some sts.

3 For style 1 continue in st. st. only.

For style 2 change to colour B T7. K. 6 rows T10. K. 1 row. Make picot as before. T7. K. 7 rows M.D.E. by picking up first row of white loops and placing on NS. C.O.R. 000.

4 Dec. 1 st. on each edge every alt. row 22 (24, 26) times to 19 (21, 23) sts. K. to 44 (50, 56) rows. Thread up back neck sts.

Right Front

1 Hem Cast on 47 (49, 51) sts. cont. as for back. C.O.R. 000. For style 1. Start patt. for right front to right of centre. (For 588 Slide dial on 6. Reverse for left s/dial on 5).

2 As for back. Rehang work over 33 (35, 37) sts. C.O.R. 000.

3 As for back.

4 Cont. arm shaping as for back. Row 30 (36, 42). On neck edge cast off 6 (7, 8) sts. Dec. 1 st. every alt. row. 5 times K. to 44 (50, 56) rows. Repeat for left front.

Sleeve

1 Cast on 35 (37, 39) sts. Odd st. to left of centre. Make hem as for back.

Single Sleeve Pattern

Select N's as for graph. (Model 588. Slide dial on 1.) Push NS to left and right of centre back to B pos. i.e. trans. one central st. to end of sleeve. C.O.R. 000.

2 Inc. 1 st. on each edge every 9 (8, 7) rows, 6 (8, 10) times to 47 (53, 59) sts. K. to 60 (66, 72) rows. C.O.R. 000. (With different coloured yarn, make mark on each edge at this point).

3 Dec. 1 st. on each edge at 000. Then dec. 1 st. on each edge every 3rd row 8 (10, 12) times and then every alt. row 10 times to 11 (13, 15) sts. K. to 44 (50, 56) rows. Cast off. Repeat.

Front Edge

Style 1. Cast on 77 (83, 89) sts. T7. K. 3 rows. Button-holes. Make holes over 5th – 7th sts. from right edge. * miss next 3 (4, 5) sts., make hole over next 3 sts. and repeat from *

Lacy Set

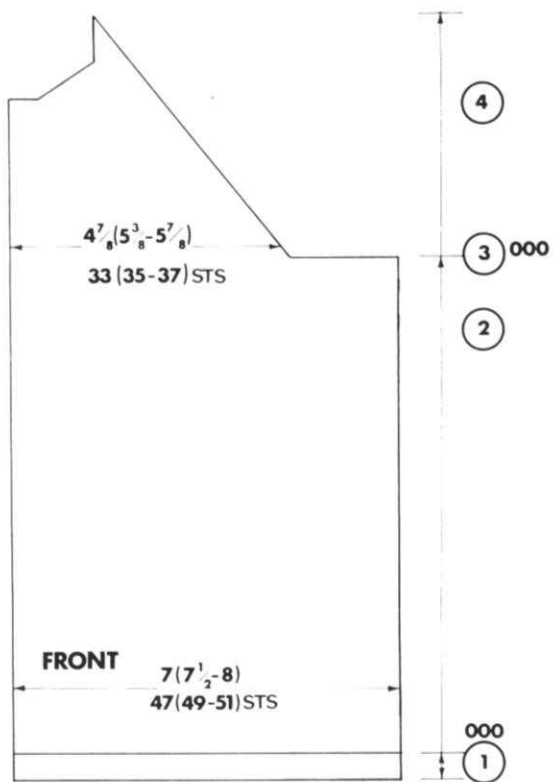
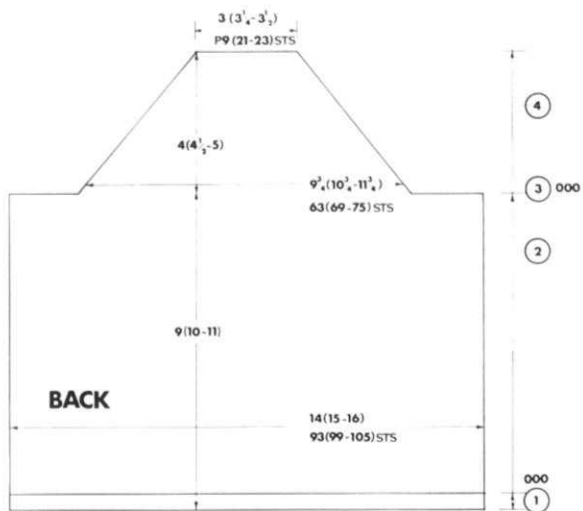

Materials

Listers Baby-Bel 3 ply courtelles, 8 x 25 gm balls for the set.

3 balls for the coat.

4 balls for the dress.

1 ball for the bonnet.

7 buttons.

2½ yds. ribbon.

No. 10 Crochet hook.

Actual measurements

Dress: Chest 20"

Sleeve 1½"

Length 15"

Coat: Chest 20"

Sleeve 5½"

Length 11"

Bonnet: 14" all around face.

Tension

T6. 7 sts. and 10 rows to 1" (when pressed) over st.st.

Dress Back

Cast on 138 sts. T6 K. 9 rows. Make a row of holes by transferring every alt. st. to adjacent needle. T7. K. 10 rows, make hem. K. 1 row (C.O.R.) T6. work from chart for 11" from picot edge (adjust length here). K. 2 rows st.st. put on waste and take off machine. Bring forward 72 needles and rehang work onto these, placing 1 st. on each of the 1st 3 needles at either end and 2 sts. on all needles between. K. 1 row. T5. K. 3 rows and make row of holes, transferring every 4th st. to adjacent needle, K. 6 rows. T6. divide for back opening putting all needles at left side of centre 0 in pos. E. H.C.L. 2 K. 8 rows (1 extra for 2nd side).

Shape Armholes

Cast off 5 sts. and make 1st buttonhole at centre edge 2 sts. in from edge, on next row. Make buttonholes on every foll. 10th row K. 1 row. Dec. 1 st. at armhole edge of next and foll. 4th row, K. 3 rows. Dec. 1 st. at beg. of every alt. row at armhole edge of next 3 alt. rows, then dec. 1 st. at armhole edge of every row to 19 sts. (23 sts. on 2nd side). Still dec. at armhole edge as before, cast off 8 sts. at beg. of next neck edge row (12 sts. on 2nd side) and dec. 1 st. at neck edge of next 3 rows, continuing armhole shaping as before until all sts. are worked off. Rejoin yarn at centre edge, casting on 4 sts. as an underlap, and work to match, reversing shapings and noting differences in sts.

Front

Work as given for back to T6. K. 8 rows. Cast off 5 sts. at beg. of next 2 rows. Dec. 1 st. at both ends of next and foll. 4th row. K. 3 rows. Dec. 1 st. at both ends of next and foll. 3 alt. rows (50 sts). With spare wool cast off centre 10 sts. Working on right hand set of sts. (left set in pos. E. H.C.L. on 2 (800 H.C.L. 1), dec. 1 st. (at armhole edge) on next row, K. 1 row. Dec. 1 st. at both ends of next row. Rep. last 2 rows 4 times. Cont. dec. 1 st. at armhole edge only of every alternate row until all sts. are worked off. Work other side to match.

Sleeves

Cast on 56 sts. T6. K. 2 rows, then (work from chart throughout) K. 10 rows.

Shape Top

Cast off 4 sts at beg. of next 2 rows. Dec. 1 st at both ends of foll. 4th row. K. 3 rows. Dec. 1 st. at both ends of

next and every foll. alt. row to 12 sts. Cast off.

Cuff

Pick up 36 sts. along bottom (cast on edge) of sleeve and hand onto machine. T5. K. 6 rows. Make a row of holes as for hem of dress T4. K. 7 rows. Cast off. Join raglan seams. Pin out and press on wrong side with a slightly warm iron over a dry cloth. Join side and sleeve seams.

Neckband

Cast on 84 sts. T7. K. 2 rows. T6. K. 1 row. make buttonhole at left edge, 2 sts. in (as on bodice) K. 1 row. T5. K. 3 rows. T4. K. 3 rows. Make a row of holes as for hem of skirt. T3. K. 3 rows. T4. K. 2 rows. T5. make a buttonhole as before K. 3 rows. T6. K. 4 rows. ending C.O.R. Hang up cast on edge to form hem, now with right side of dress towards machine and starting from back neck opening hang 14 sts. from back neck 10 sts. from sleeve, 11 sts. along side edge of neck, 10 sts. from front neck and cast the band and garment sts. off together to this point, then pick up 11 sts. along side edge of neck, 10 sts from top of sleeve and 18 sts. along back neck. Cast these sts. off together as before. Work a row of double crochet around back opening. Neaten buttonhole. Press seams and neckband. Sew on buttons and thread in ribbon.

Bonnet

Cast on 88 sts. T4. K. 14 rows. Make 1 row of holes as for hem of dress T5. K. 14 rows. Make hem. K. 2 rows. T6. work from chart for 5½ ins. from picot edge. Cast off 28 sts. at beg. of next 2 rows. (Continue working from chart) work 36 rows, dec. 1 st. at both ends of every 6th row. Cast off pin out and press work as before. Join cast off (28) sts. from crown to side edges of back flap, and press. Work 2 rows of double crochet round neck edges only of bonnet easing in slightly to fit. Sew ribbon ties on.

Coat

Worked all in one piece to the armholes. Cast on 200 sts. T6. K. 9 rows. Make a row of holes as given for hem of dress. T7. K. 10 rows. Make hem, K. 1 row C.O.R. T6. work from chart for 5½ ins. (or desired length) K. 2 rows plain, put on holder or waste and take off machine. Re-hang over 136 needles evenly all across work. T5. K. 10 rows. T6. K. 8 rows. Put all but 39 sts. at right end of work on waste or a holder. With C.O.R. K. 1 row. Shape.

Shape Armhole

Cast off 8 sts. at beg. of next row. K. 1 row. Dec. 1 st. at beg. of next (armhole edge) and foll. 4th row twice, then every alt. row at the same edge to 20 sts. Dec. 1 st. at both ends of next 4 alt. rows, then still dec. 1 st. at neck edge of every alt. row, dec. 1 st. at armhole edge of every row until all sts. are worked off. Return to work left on holder and hang up 39 sts. from left end and work other front to match, reversing all shapings.

Hang up remaining sts. for back. Dec 1 st. at both ends of next and foll 4th row twice, then both ends of every alt. row to 34 sts. then both ends of every row to 18 sts. Cast off.

Sleeves

Cast on 56 sts. T6. K. 4 rows. then work from chart. (throughout) to 5½ ins.

Shape Top

Cast off 3 sts. at beg. of next 2 rows work 4 rows, dec. 1 st. at both ends of next, work 4 rows. Dec. 1 st. at both ends of next and every foll alt. row to 32 sts. Dec. 1 st. at both ends of every row to 8 sts. K. 1 row. Cast off.

Cuff

Pick up 36 sts. from cast on edge of sleeve and hang onto machine. T5. K. 8 rows. Make a row of holes as for dress hem. T4. K. 9 rows. Cast off. Sew up cuff edges neatly. Pin out and press all pieces. Join sleeve seams and sew up raglan seams.

Banding

Bring forward 180 needles and with right side of work

towards machine, pick up 60 sts. along front edge of coat, from picot edge to front slope, 16 sts. along slope to sleeve, 6 sts. along sleeve top, 16 sts. across back neck, 6 sts. across top of 2nd sleeve, 16 sts. down other front slope, and 60 down straight edge to hem. T6. K. 3 rows, make 3 buttonholes (evenly spaced) between waist and front slope. K. 4 more rows. Make a row of holes as given for dress hem. T5. K. 5 rows. Make another set of buttonholes over the same needles as before, K. 4 rows. Cast off.

To Complete

Sew banding down neatly sew round buttonholes Press banding and seams. Sew on buttons.

												21 21															
												O 20 20															
												O 19 19															
												18 18															
												O 17 17															
												O 16 16				7		C ←									
												15 15		I				7		C ←							
												O 14 14						7		C ←							
												O 13 13		I						C ←							
												12 12						7		C ←							
												O 11 11		I						C ←							
												10 10								C ←							
												9 9						7		C ←							
												O 8 8		2						C ←							
												7 7				6				C ←							
												6 6		I 3						C ←							
												O 5 5				5 7				C ←							
												4 4		2						C ←							
												3 3				6				C ←							
												O 2 2		3						C ←							
												1 1				5				C ←							
S.J.L.	K.C.	L.C.	S.L.	K.H.800 MACHINE												STEPS	STEPS	K.H.588 MACHINE								K.C.	L.C.
				1	2	3	4	5	6	7	8	9	10	11	12	1	2	3	4	5	6	7	8				

Bib, Cardigan and Trews

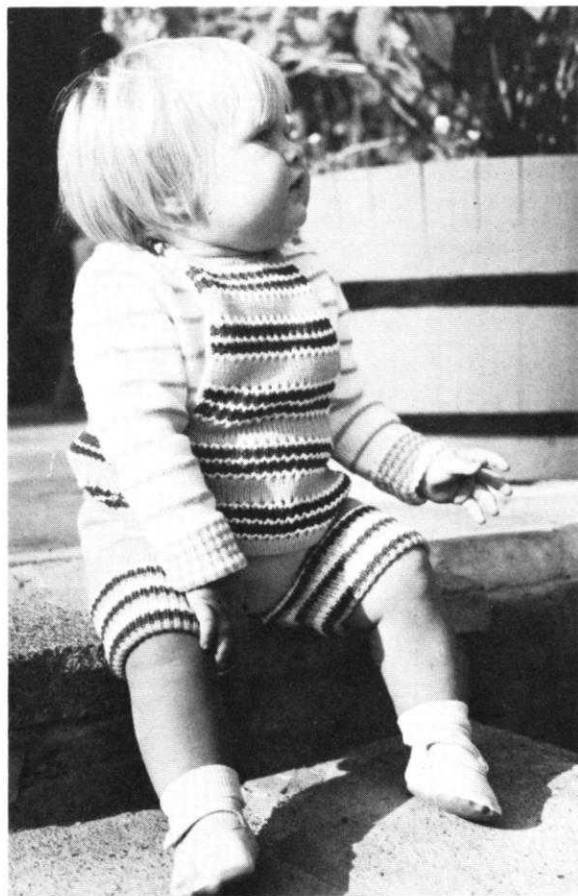

Materials

Jumper 3 (4, 4) ozs. Colour A. Robin Tricel Nylon
1 oz. Colour B Perle
12 small buttons.

Shorts 3 (3, 4) ozs. Colour B.

1 oz. each Colours A and C

Bib A 1 oz. each of A, B and C Colours

Bib B 2 ozs. Colour C

1 small button for each bib.

Measurements

To fit 18 (20, 22) in. chest.

Finished measurements 19 (21, 23) in. chest.

Length at back $9\frac{1}{2}$ ($10\frac{1}{2}$, 11) ins.

Sleeve seam 7 ($7\frac{1}{2}$, 8) ins.

Tension

$7\frac{1}{2}$ sts. x 12 rows to 1 in. T6. over stocking st.

Back

1 Ribbers. Cast on 71 (79, 87) sts. in colour A, as for 1 x 1 rib. T1/1. K. 4 rows tubular. T3/3. K. 12 rows rib. Trans. NS to M.B. C.O.R. 000.

Single Bed M/Cs. Cast on 71 (79, 87) sts. in colour A. T4. K. 12 rows T7. K. 1 row T4. K. 12 rows M.D.E. T6. K. 1 row. C.O.R. 000.

2 T6. K. 4 rows. * colour B K. 2 rows. Colour A K. 10 rows * Repeat this stripe sequence from * to * to end of garment. K. to 54 (60, 66) rows.

3 Cast off 4 sts. at beg. next 2 rows to 63 (71, 79) sts.

4 Dec. 1 st. on each edge every 6th row, 3 times to 57 (69, 73) sts. 18 rows.

5 K. 22 (26, 30) rows straight to shoulder.

6 Cast off 6 (7, 8) sts. at beg. next 4 rows then cast off 5 (6, 7) sts. Leaving 23 (25, 27) back neck sts. Thread up base stitches.

Front

1 2 3 and **4** as for back.

5 K. 10 (14, 18) rows to front neck. Cast off centre 11 (13, 15) sts. H.C.L. III (800 H.C.L. 1) Push left NS to E. pos. On neck edge dec. 1 st. every alt. row 6 times. K. to 22 (26, 30) rows.

6 As for back.

H.C.L. I. (800 H.C.L. 3) Repeat **5** reversing shapings on neck edge.

Sleeves

1 Ribbers. Cast on 41 (45, 49) sts. in Colour A as for 1 x 1 rib T1/1. K. 4 rows tub., * colour B T3/3. K. 2 rows, colour A K. 2 rows * repeat to 24 rows. Trans. NS to MB. C.O.R. 000.

Single Bed M/Cs. Cast on 41 (45, 49) sts. and make hem as back.

2 Colour A K. 10 rows. Repeat stripe sequence * to * as for back to end.

Inc. 1 st. on each edge every 7 (8, 9) rows, 9 times to 59 (63, 67) sts. K. to 72 (78, 84) rows.

3 Cast off 4 sts. at beg. next 2 rows to 51 (55, 59) sts.

4 Dec. 1 st. at beg. every row 22 (26, 30) times to 29 sts.

5 Dec. 1 st. each edge every row 9 times to 11 sts. K. 1 row. Cast off repeat sleeve.

Shoulder/Neck Bands

Ribbers. Colour B cast on 53 (65, 73) sts. T1/1. K. 4 rows tubular. Colour A T3/3. K. 2 rows. Buttonholes, starting **3** (4, 5) sts. in from each edge * make buttonholes over 3 sts., miss 2 (3, 4) sts. * repeat buttonholes from * to * 2 times more. Colour B K. 2 rows. Trans NS to MB.

Single Bed M/Cs. Colour B cast on 53 (67, 73) sts. T4. K. 2 rows. Colour A K. 2 rows. Make buttonholes as above. Colour B K. 2 rows T7. K. 1 T4. K. 2 rows, make buttonholes. Colour A K. 2 rows. Colour B K. 2 M.D.E.

Press back and front, with right side of work facing M/C place shoulder to first 17 (20, 23) NS. neck to next 23 (25, 27) sts. and shoulder to rest of sts. Cast off to end. Repeat band for back, omitting buttonholes and cast off in same way.

To Make Up

Press sleeves. Pin front shoulder band onto back band. Sew tops of sleeves into armholes, sewing through both bands. Join side and sleeve seams turning back ribbed cuffs and secure into place. Finish off buttonholes. Press all seams and bands. Sew buttons onto each shoulder to correspond with holes.

Shorts

1 Ribbers. Cast on 85 (93, 101) sts. as 1 x 1 rib in colour A. T1/1. K. 4 rows Tub. T3/3 * K. 4 rows colour C, 4 rows colour B, 4 rows colour A* repeat from * to * to 64 rows Trans. ribber NS to M.B. C.O.R. 000.

Single Bed M/Cs. Cast on 43 (47, 50) sts. overall. NS with W. wl. K. a few rows, change to colour B T3. K. 32 rows. T5. K. 1 row. T3.* colour C K. 4 rows, colour A K. 4 rows, colour B. K. 4 rows * repeat this stripe sequence to 65 rows. M.D.E. 85 (93, 101) sts. Unravel waste wool. Colour B T6. K. 1 row. C.O.R. 000.

2 T6. K. 6 rows.

3 Cast off 4 sts. K. 1 row, cast off 6 sts., K. 1 row. C.O.R. 000.

4 On right edge, dec. 1 st. every 6th row 4 times - (24 rows). At the same time on left edge dec. 1 st. every 16 (19, 22) rows 4 times to 67 (75, 83) sts. K. to 68 (78, 88) rows. C.O.R. 000.

5 K. 1 row H.C.L. 111 (800 H.C.L. 1) push 35 (39, 43) NS on right of M/C to E pos. K. 2 rows. Always taking yarn round inside N. push 8 (9, 10) NS to E. pos. at opp. end to carr. at beg. every alt. row 4 times H.C.L.'s I (800 H.C.L. 3) K. 1 row and cast off. Repeat from **1** for left leg, reversing all shapings. Press both pieces and join front crutch seam.

Waist Band

Cast on 132 (148, 164) sts. in colour B. T4. K. 10. T7. K. 1 T4. K. 10 rows. M.D.E. Hang work evenly onto M/C and cast off to end. Close back seam, inserting $\frac{1}{2}$ " (by desired length) elastic into waistband. Turn back rib cuffs and join seams. Secure cuffs in place. Press all seams.

Bib A

1 C.O.B.H. 105 (113, 121) sts. in colour B.

T4. K. 7 rows T7. K. 1 T4. K. 7 rows M.D.E. T6. K. 1 row. C.O.R. 000.

2 These 5 steps make the pattern repeat to end of garment:

1 *Trans. every alt. N by moving LC from left to right.

2 Colour A K. 2 rows. Trans. every alt. N. by moving L.C from right to left.*

3 Colour C K. 4 rows. Repeat from * to *.

4 Colour C K. 4 rows. Repeat from * to *.

5 Colour B K. 10 rows.

Knit to 42 rows.

3 Cast off 37 (39, 41) sts. at beg. next 2 rows to 31 (35, 39) sts. C.O.R. 000.

4 K. to 60 (70, 80) rows. C.O.R. 000.

5 Cast off centre 7 (11, 15) sts.

Thread up sts. on left of machine. Right strap on neck edge. Dec. 1 st. every alt. row 5 times to 7 sts. K. to 36 (38, 40) rows and cast off. Repeat for left strap, reversing neck shaping.

Bib B

In colour C K. as for A, in st. st. omitting stripe pattern. Decorate bib if desired by swiss darning a little bear from graph.

To Make Up

Press bib and work a double row of crochet round all raw edges. Work three loops on each edge and a loop on one strap. Press. Sew a button onto strap to correspond with loop. Sew six buttons, three on each side of back of jumper, to correspond with loops of bib.

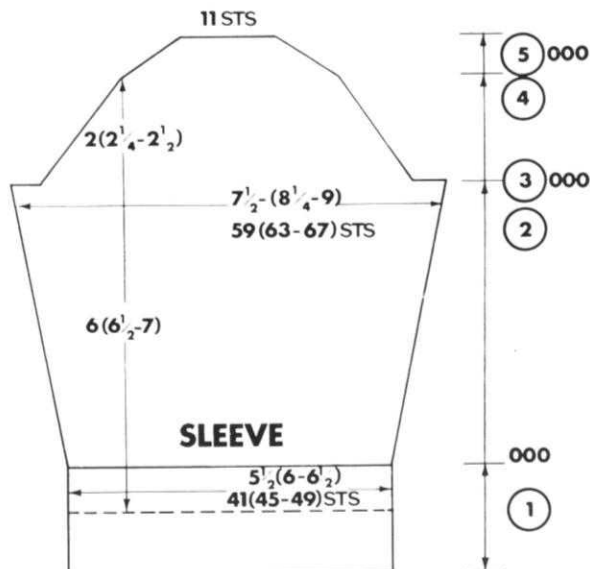
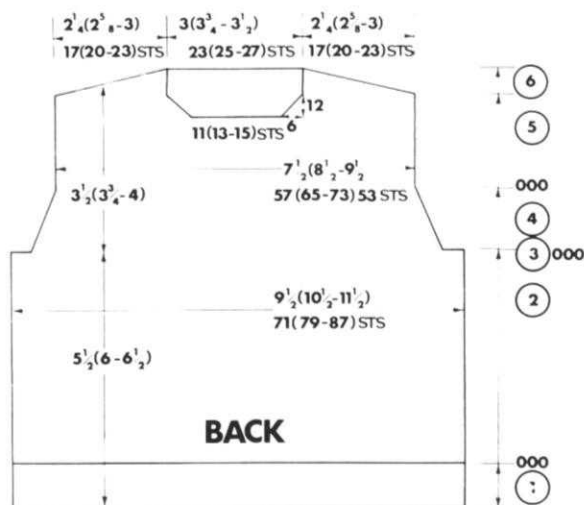

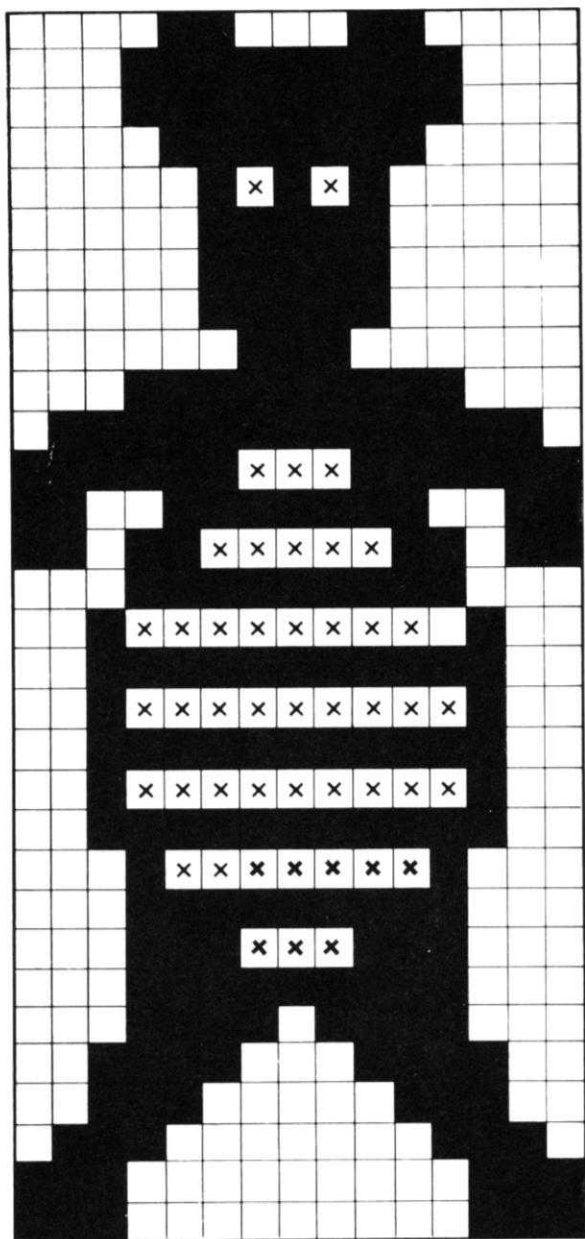

■ = colour A
 x = colour B

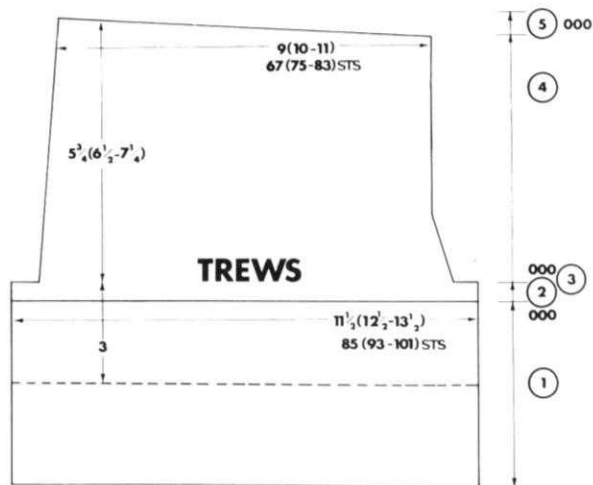
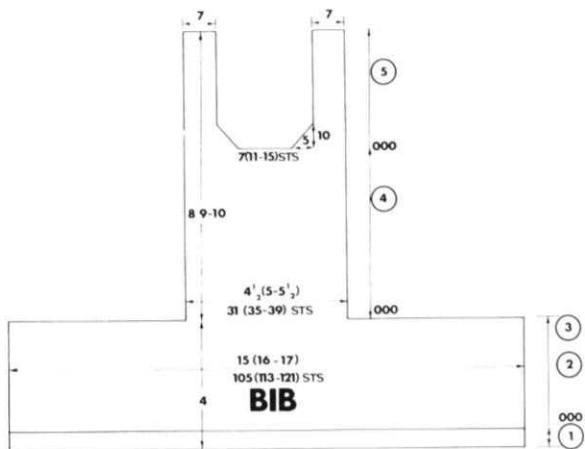

Top and Booties

Materials

3 (4) ozs. Patons Nylox 3 ply white. Small ball of each of 2 contrast shades. Patons Purple Heather 4 ply Turquoise and red. 3 small white buttons.

Measurements

To fit 18 (20) chest.

Tension

$7\frac{1}{2}$ sts. and 11 rows equals 1 in. over st. st. on T5.

Neck Band

Press back and front. Join shoulder seams. With right side of work facing machine and working from right edge of needles, place the right half back neck to first 11 (12) needles, front side neck to next 8 needles, front neck to next 14 (16) needles, cast off band and neck edge together to this point, place remainder of neck to rest of needles and cast off band and neck edge together.

Back Openings

With right side of work facing machine and working from right edge of needles place opening evenly onto all needles and cast off band and edge together.

Rouleaux (in red) Knit 2.

C.O.B.H. 2 sts. Knit 4 rows.

One P.B. in on carriage Knit 2 rows. T3. Knit until rouleau measures 15 ins.

Back Opening Loops (In main yarn – white)

One P.B. in on carriage. T1, Knit 1 st. until rouleau measures 6 ins. approx.

To introduce the colour for the smocked effect, where the sts. have been gathered, a colour of your own choice can be used to sew round the gathered sts., to give the same effect as the illus.

Bootee

1 Picot hem – C.O.B.H. 49 (53, 57) sts. T4. Knit 6. T6. Knit 1 for foldline. Make picot edge as for dress. T4. Knit 7. C.O.R., M.D.E. 000.

2 Dec. 1 st. every 6th row to 41 (45, 49) sts. Knit to row 28 fin. C.O.R. Thread up 20 (22, 24), N.B. Start pull up pattern on row 4 and finish on row 24.

3 Knit 16 rows (adj. length here if required).

4 Toe (SEE NOTES).

5 Knit 16 rows (adjust length here if required).

6 Knit on waste yarn heel (SEE NOTES).

Notes

1 To shape toe and heel H.C.L's to II (800 H.C.L. 1). Push 1 needle at opp. end to carriage into E pos. on next 12 rows. *Always taking yarn round first inside needle. Push 1 inside needle at opp. end to carr. from E to D pos. on next 12 rows.

2 Work other bootee in reverse. Knit rouleaux in red 5 ins. long.

Dress Back

1 Picot hem. For all m. C.O.B.H. 98 (106) sts. T4. Knit 6 rows. T6. Knit 1 row for foldline. C.O.L. Trans. every a.t. needle by moving L.C. from right to left. T4. Knit 7 rows. M.D.E. C.O.R. 000.

2 Dec. 1 st. each end of every 7th row to 72 (80) sts. Last dec. row 91. Knit straight to row 94 (100). (Adjust length if required). Fin. C.O.R. N.B. Row 84 (90) set.

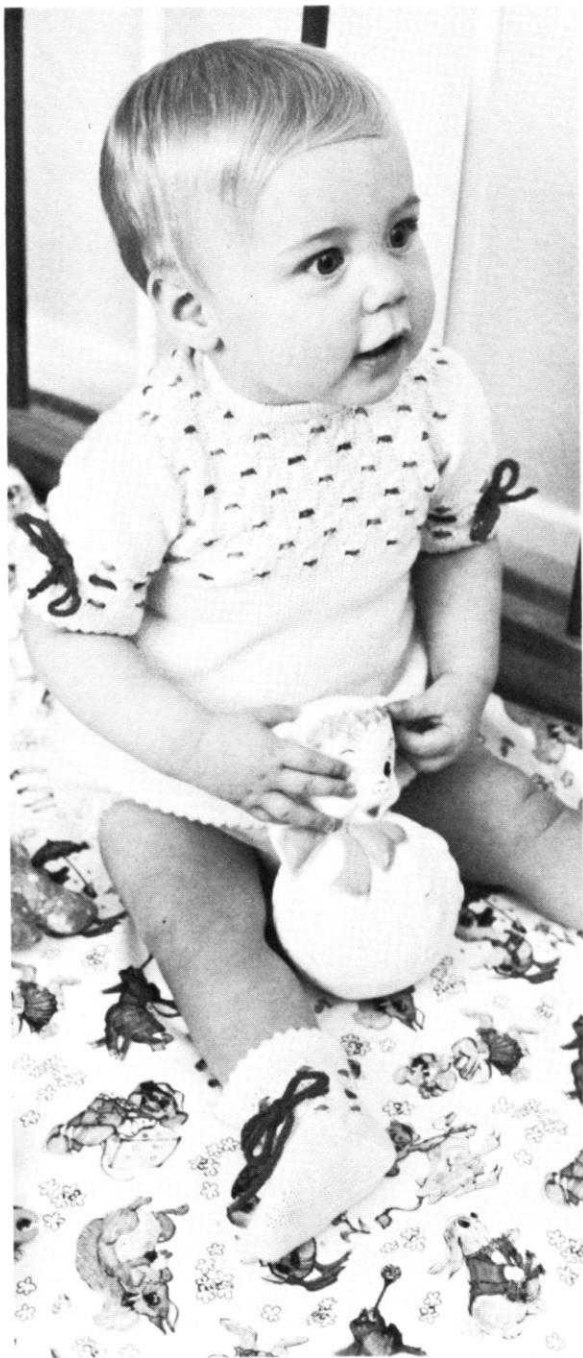

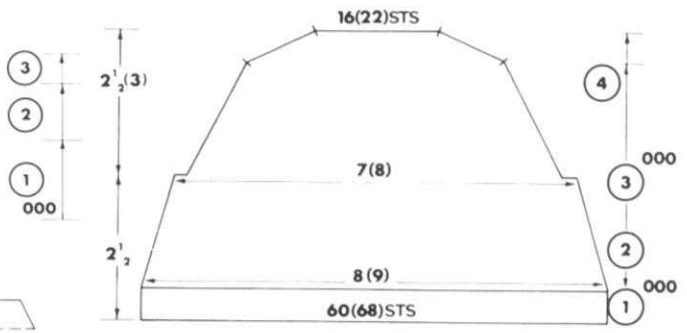
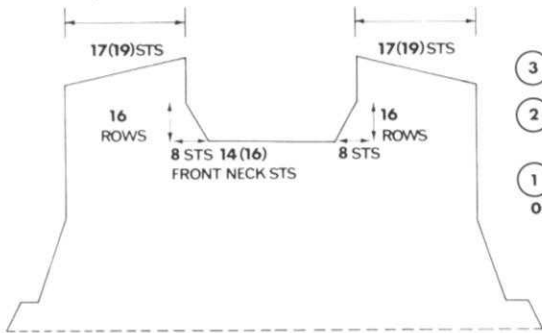

→	3																									24
←	"																									23
→	"																									22
←	2	\			O																	O				21
→	3																									20
←	"																									19
→	"																									18
←	2	\				O																O				17
→	3																									16
←	"																									15
→	"																									14
←	2	\					O				O															13
→	3																									12
←	"																									11
→	"																									10
←	2	\					O				O															9
→	3																									8
←	"																									7
→	"																									6
←	2	\					O				O															5
→	3																									4
←	"																									3
→	"																									2
←	2	\					O				O															1
	H.C.L																									
		1	2	3	4	5	6	7	8	9	10	11	12	STEPS	STEPS	1	2	3	4	5	6	7	8	H.C.L.LEFT	H.C.L.RIGHT	K.DIR.
	K.H. 800 MACHINE												K.H. 588 MACHINE													

H.C.L.'s to III (800 H.C.L. I) to start pull up pattern. N.B. Pull up pattern starts row 84 (90).

3 Cast off 3 (4) sts. each end. Fin. C.O.R. 66 (72) sts. 000.

4 16 rows. Dec. 1 st. each end of every 3rd row to 28 (31) sts. Knit 1 row. Fin. C.O.R. 000.

5 Knit 28 (34) rows straight.

6 On shoulder cast off 6 sts. at beg. of next row. Then cast off 5 (7) sts. at beg. of next row; thread up remaining 11 (12) back neck sts.

Sleeve

1 Cast on 60 (68) sts. and make hem as for skirt.

2 Dec. 1 st. each end of every 5th row to 52 (60) sts. Knit to row 22. Fin. C.O.R. (N.B. row 4 set H.C.L. to III) (800 H.C.L. I) to start pull up pattern).

3 Cast off 3 (4) sts. each end. Fin. C.O.R. 46 (52) sts. 000.

4 Dec. 1 st. each end of every 4th row to 34 (40) sts. Fin. C.O.R. 24 (30 rows). Cast off 3 sts. at beg. of every row to 16 (22) sts. (6 rows).

Dress Front Same as back **1, 2, 3** and **4** then

1 Knit to 16 (20) rows. Thread up and take off M.C., the centre 14 (16) sts. 000 and place one shoulder on to stitch holder.

2 Dec. 1 st. every row at neck edge to 17 (19) sts. Then knit to 28 (34) rows.

3 6 rows shoulder shaping as for back.

4 Repeat reversing shaping for other shoulder taking care to replace sts. from stitch holder on to the same needles they came from.

Neck Band

C.O.B.H. 52 (56) sts. T4. Knit 6 rows. T6. Knit 1 row for foldline. T4. Knit 6 rows. M.D.E.

Back Openings

C.O.B.H. 26 (30) sts. T4. Knit 6. T6. Knit 1. T4. Knit 6. M.D.E.

To Make Up

Sew smocking on back and front dress.

Smocking

Working in first contrast colour, sew through the holes created by the pull up sts., working over each hole three times before passing to next st. Work next and alt. rows in second colour.

Press sleeves. Work first and last pull up sts. in second colour as above. Sew tops of sleeves into armholes. Join side and sleeve seams. Sew in all ends of yarn. Press all seams. Press neck band into curve to fit neck. Make 3 loops evenly up back opening. Sew on buttons to correspond with loops. Thread rouleaux through middle row of pull up sts. on sleeves.

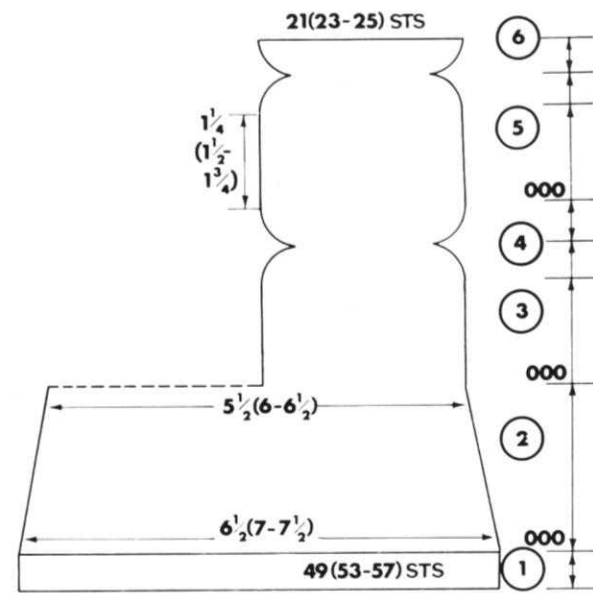
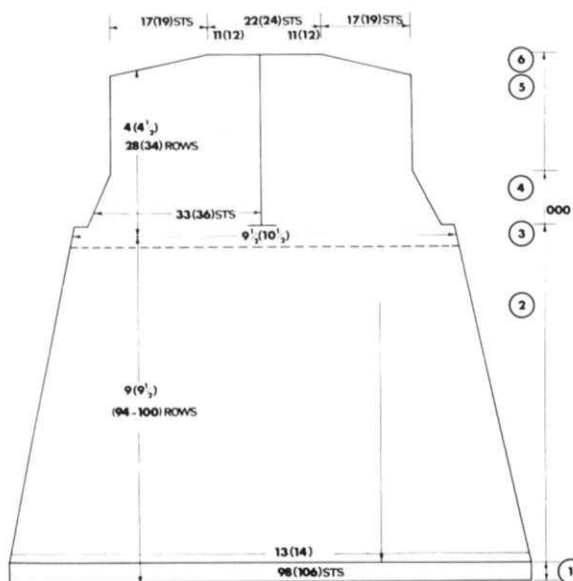

Dress and Knickers

Materials

Robin Tricel Nylon Perle 4 ply
Angel dress 4 (4, 5) ozs.
Knickers 2 ozs.
Plus 1 oz. strong contrast colour for linings
3 small buttons
 $\frac{1}{2}$ in. elastic (to desired length) for knickers

Measurements

Dress to fit 18 (20, 22) in. chest
Finished measurements 19 (21, 23) in. chest
Length from back neck to hem $11\frac{1}{2}$ (13, $14\frac{1}{2}$) ins.

Tension

7 sts x 11 rows to 1 in. on T7. over stocking st.
7 sts x 11 rows to 1 in. on T6. over lace patt.

Back

1 C.O.B.H. 89 (95, 101) sts. Extra st. to left of centre T5. K. 6 T7. K. 1 row. Make picot by trans. every alt. N from right to left using L.C., T5. K. 7 rows, M.D.E. COR. T7. H.C.L.'s II (800 H.C.L.1) push left 24 NS. to E pos. K. 1 row. Push right 24N to E pos., always taking yarn round inside needle. K. 1 row. *Return 8 NS to C pos. at opp. end to carr * Repeat from * 5 more times until all NS are in B. pos. C.O.R. 000.

2 Start lace patt. one from graph and repeat sequence to end of back, dec. 1 st. at each edge every 7 (8, 9) rows 10 times to 69 (75, 81) sts. K. to 80 (90, 100) rows.

3 Cast off 3 (4, 5) sts. at beg., next 2 rows to 63 (67, 71) sts. Thread up sts. to left of centre take off M/C. C.O.R. 000.

4 Dec. 1 st. on armhole edge every 3 rows 5 times to 22 (32, 30) sts. K. to 16 rows. C.O.R. 000.

5 K. 16 (22, 28) rows to shoulder.

6 Cast off 5 NS. K. 2 rows. Cast off 4 (5, 5) NS K. 2 rows. Cast off 4 (4, 5) NS K. 2 rows. Thread up remaining 13 (14, 15) back neck sts. Replace left sts. back onto M/C to left of centre O. Repeat from 4 reversing all shapings. 1 extra sts. at back neck.

Front Neck & Lining

Lining

In contrast colour C.O.B.H. 63 (67, 71) sts. T7.

4 As for back.

5 K. 8 (14, 20) rows to front neck. Cast off centre 13 (15, 17) sts. Thread up last stitches and take off M/C. Right neck: dec. 1 st. on neck edge every row 7 times to 13 (14, 15) sts. K. to 16 (22, 28) rows.

6 As for back, place left neck sts. on to M/C and repeat from 5 as above reversing all shapings.

Dress Front

Repeat steps **1**, **2** and **3** as for back to * 63 (67, 71) sts. With purl side of lining facing M/C place edge onto NS. Start patt two from graph T6. **4**, **5** and **6** as for lining.

Sleeves

C.O.B.H. 49 (55, 61) sts. Make hem as for back T7. K. 2 make one repeat of patt. one - (6 rows) H.C.L.'s II (800 H.C.L.1) push 18 NS to E. Pos. at opp. end to carr. for next two rows. Always taking yarn round inside N, push 2 NS back to C pos. at opp. end to carr. on next 18 rows until all NS are in B pos. Cast off. Repeat Sleeves.

To Make Up



Press back, front and sleeves. Join shoulder seams working through lining and front.

Neck Band

C.O.B.H. 61 (65, 69) sts. * T5. inc. 1 st. at beg. of every row 6 times – (6 rows) T7. K. 1 row. Make picot as for hem T5. dec. 1 st. at beg. every row 6 times – K. to 14 rows M.D.E. * Place $\frac{1}{2}$ back neck to first 14 (15, 16) NS working through both front and lining place side neck to next 11 sts, and front neck to 13 (15, 17) sts. Cast off up to this point. Place rest of neck to remainder of NS in the same way. Cast off to end.

Back Bands

C.O.B.H. 27 (29, 31) sts. Make band as for neck band. Hang opening evenly onto NS and cast off to end. Repeat for other opening. Sew sleeves into armholes. Join side seams. Finish off neck bands.

Rouleau

C.O.B.H. 2 NS. push 1 part button in T3. K. to 4 ins. approx. Thread rouleau through left back band making 3 loops and secure in place. Press all seams and bands. Sew 3 buttons onto right band to correspond with loops.

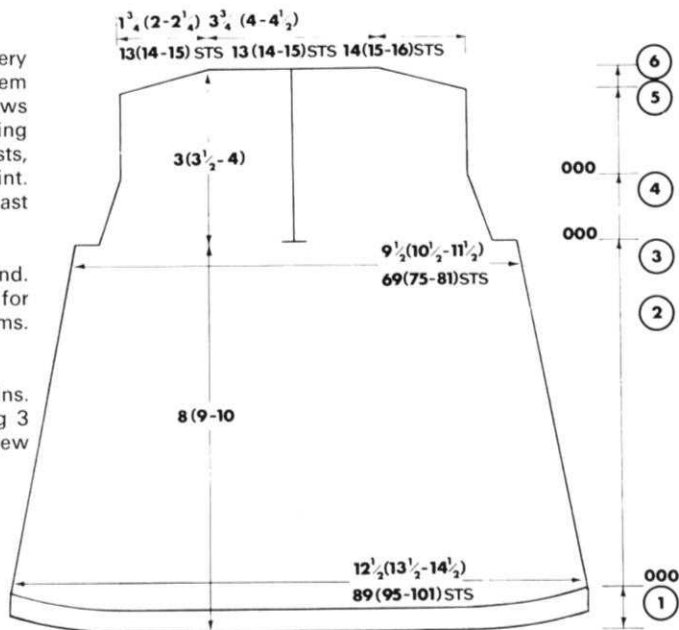

				K.H. 800 MACHINE														K.H. 588 MACHINE											
4	3	2	1	1	2	3	4	5	6	7	8	9	10	11	12	STEPS	STEPS	1	2	3	4	5	6	7	8	1	2		
S.I.L.	K.CARR	L.CARR	S.L.																							L.CARR	K.CARR		
↕	↕	↕	↘						○							12	12					■						↔	↔
↕	↕	↕	↘						○							11	11					■						↔	↔
↕	↕	↕	↘											○		10	10								■			↔	↔
↕	↕	↕	↘						○							9	9					■						↔	↔
↕	↕	↕	↘											○		8	8									■		↔	↔
↕	↕	↕	↘						○							7	7					■						↔	↔
↕	↕	↕	↘											○		6	6										■	↔	↔
↕	↕	↕	↘												○	5	5					■						↔	↔
↕	↕	↕	↘						○							4	4										■	↔	↔
↕	↕	↕	↘											○		3	3									■		↔	↔
↕	↕	↕	↘												○	2	2									■		↔	↔
↕	↕	↕	↘												○	1	1									■		↔	↔

Jumper and Rompers

Knickers

Back

1 C.O.B.H. 15 (17, 19) NS extra N to left of centre T7. K. 2 rows C.O.R. 000. Inc. 1 st. on each edge every row 18 (20, 22) times. Then inc. 1 st. each edge every alt. row 7 times to 65 (71, 77) sts. K. to 34 (36, 38) rows.

2 K. 36 (42, 48) rows.

3 Waistband - T5. K. 8, T7. K. 1 row, T5. K. 8 M.D.E. Cast off.

Lining

Repeat steps **1** and **2** as for back and cast off.

Front

T6. repeat steps **1** and **2** in lace patt. two from graph. **3** with right side of lining facing M/C place sts. onto NS. repeat waist band as for back.

To Make Up

Working through lining and front join side seams to back piece.

Legbands

C.O.B.H. 59 (63, 67) sts. T5. K. 8, T7. K. 1 row, make picot as for 1 back T5. K. 9 rows. M.D.E.

Working through lining and front, place to $\frac{1}{2}$ NS. Place back to rest of NS and cast off. Repeat for other leg. Join crutch seam, securing lining. Thread $\frac{1}{4}$ in. elastic (to desired length) through bands.

Press all seams.

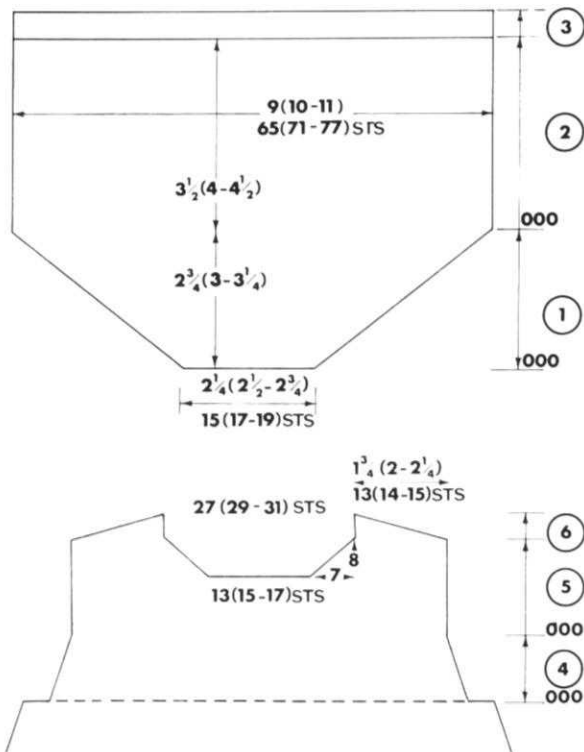

Materials

Rompers: 4 (5, 5) ozs. Robin Wools - Tricel Nylon
1 oz. contrast colour Perle - 4 ply
8 small button and buckle for belt.

Measurements

To fit 16" (18, 29)" chest.

Length from back neck to crutch 13 $\frac{1}{2}$ (15, 16 $\frac{1}{2}$) ins.

Tension 6 sts. and 17 rows = 1" on T9 over pattern.

Rompers

6 sts. x 17 rows equals 1 in. on T9. over pattern.

1 C.O.B.H. 15 (17, 19) sts. (extra st. on left) T6. K. 2 rows. T9. COR. 000 start pattern 1 from graph. Inc. 1st at beg. of every row 38 (42, 46) times to 53 (59, 65) sts. COR. 000.

2 Dec 1st on each edge every 22 (25, 28) rows, 3 times to 45 (53, 59) sts. K. to 68 (76, 84) rows, COR. 000.

3 For back only thread up sts. to left of centre 0 and take off M/C.

Romper Suit

Back and front

52 (60, 68) rows straight COR. 000.

4 Dec. 1 st. at 000. Then dec 1 st. on raglan edge, every 4th row 9 (10, 11) times *at the same time* at row 24 (28, 32).

For Front

Cast off centre 8 (12, 16) sts. and thread up left neck sts. and take off M/C. On neck edge dec. 1 st. every alt. row 9 times K. to 42 (46, 50) rows. Place left sts. back onto M/C repeat reversing shapings.

Back

Dec. on raglan edge to 42 (46, 50) rows. Cast off 4 (6, 8) back neck sts.

Place left 24 (27, 30) sts. back onto M/C and continue from **3** to end reversing raglan shapings.

Sleeve

1 Hem. C.O.B.H. 29 (33, 37) sts. Colour B. T5. K. 2 rows K. one repeat of pattern 2. from graph to 15 rows T7. K. 1 T4. K. 15 M.D.E. T6. K. 1 Colour A. pattern 1. T9.

2 Inc. 1 st. on each edge every 15 (14, 13) rows 5 (6, 7) times K. to 76 (84, 92) rows. Mark edges here.

3 Dec. 1 st. on each edge every 3rd row 4 times then dec. 1 st at beg. of every row 20 (24, 28) times to 11 (13, 15) sts. K. to 32 (36, 40) rows.

Cast off. Repeat sleeve.

Press back and front. Join raglans. Join side and sleeve seams.

Crutch bands

C.O.B.H. 15 (17, 19) sts.

T4. K. 4 rows. Working 3 sts. in from each edge make 2 buttonholes over 3 sts each. K. 4 rows T7. K. 1 T4. K. 4 make 2 buttonholes as before K. 4 M.D.E. Hang front crutch edge evenly onto NS and cast off to end. Repeat back omitting buttonholes.

Neck Band

C.O.B.H. 67 (79, 91) sts. in colour B. T5. K. 2 rows K. one repeat of pattern 2 from graph. Repeat steps 4-7. rp. steps 8-11. rp. steps 4-11. K. 2 rows to 30 rows T7. K. 1 row T4. K. 30 rows M.D.E. With right side of work facing M/C place $\frac{1}{2}$ back neck to first 12 (14, 16) NS sleeve to 9 (11, 13) NS. side neck to 9 NS and front neck to 8 (12, 16) NS. Place rest of neck to remainder of NS and cast off to end.

Backbands

C.O.B.H. 49 (54, 59) sts.

T4. K. 4 rows working 3 NS in from each edge make 6 buttonholes each over 3 NS leaving 5 (6, 7) N spacing between holes K. 4 rows T7. K. 1 T4. K. 4 make holes as above K. 4 M.D.E.

Hang right back opening evenly onto NS and cast off. Repeat for left band omitting holes.

To Make Up

Finish off buttonholes and bands. Crochet round legs. Press all seams. Sew 6 buttons onto back band and 2 buttons onto crutch band, to correspond with holes.

Belt

C.O.B.H. 87 (99, 111) sts. in colour B. T4. K. 8 rows T7. K. 1 row. T5. K. 1 repeat of pattern two from graph K. 2 rows T7. K. 1 row T4. K. 8 rows. M.D.E. and cast off. Press belt and attach to buckle.

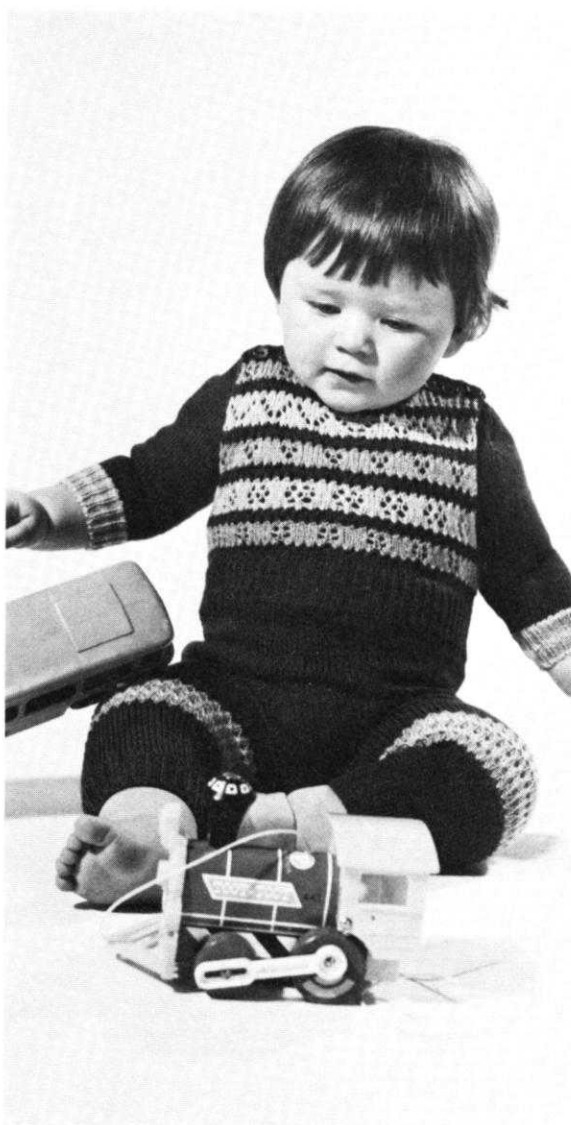

Materials

Lister or Lee Target Tricel with Nylon crepe. 4 ply.

Jumper colour A 4 (4, 5) ozs.

1 oz. each of 2 contrast colours

6 small buttons

Rompers Main colour 5 (5, 6) ozs.

$\frac{1}{2}$ in. elastic (to desired length, small button for motif)

1 oz. each contrast colour.

Measurements

To fit 18 (20, 22) in. chest

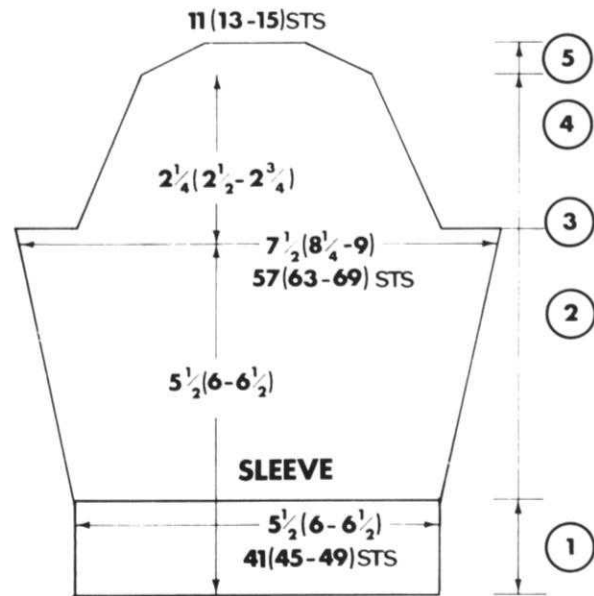
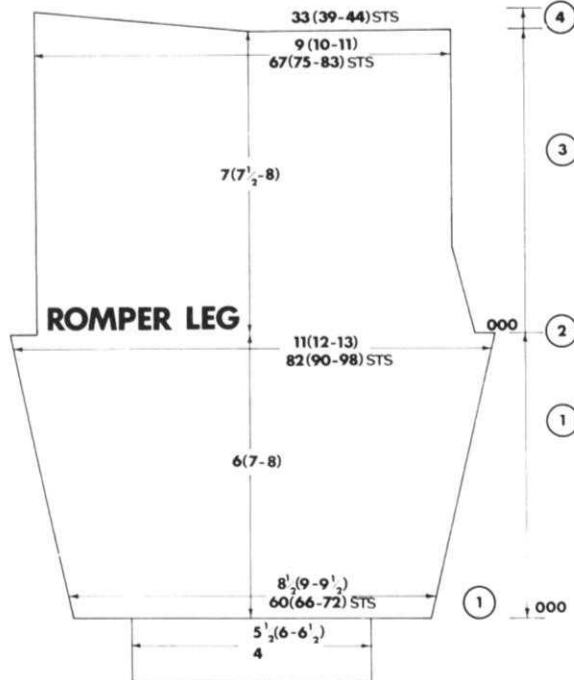
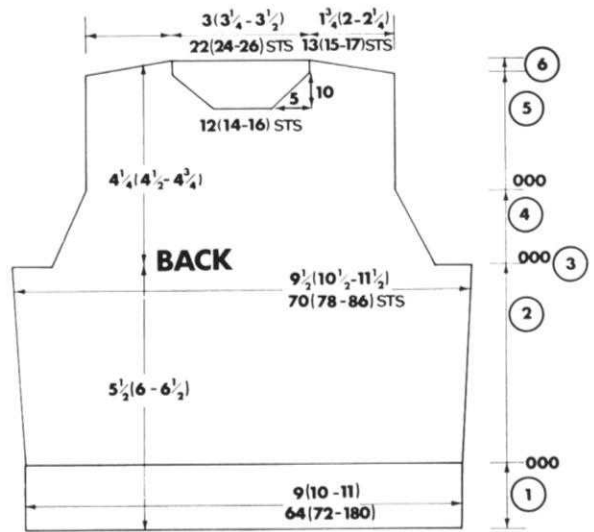
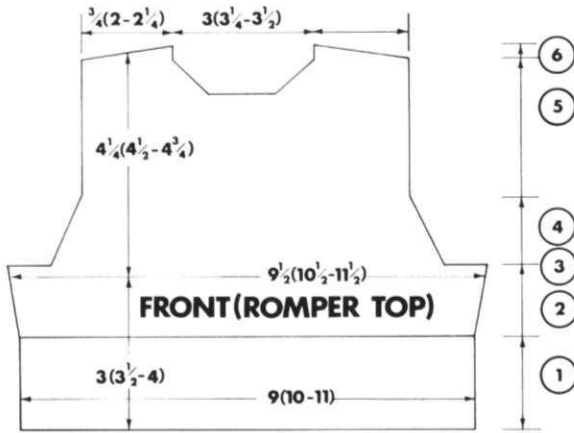

Finished measurements 19 (21, 23) in. chest
 Rompers inside leg $7\frac{1}{2}$ ($8\frac{1}{2}$, $9\frac{1}{2}$) ins.
 Length from shoulders to hem $22\frac{3}{4}$ (25, $27\frac{1}{4}$) ins.

Tension

$7\frac{1}{2}$ sts x 11 rows to 1 in. T6.

Jumper

Back

1 Ribbers. Cast on 65 (73, 81) sts. in colour C. T2/2. K. 4 rows Tubular T3/3.* colour B K. 4 rows colour C K. 4* repeat stripe sequence * to * to 16 rows. Trans. NS. to M.B. dec. 1 st. to 64 (72, 80) sts. C.O.R. 000.

Single Bed M/Cs. C.O.B.H. 64 (72, 80) sts. in colour C. T5. K. 16 rows T7. K. 1 row * (colour C) T5. K. 4 rows. Colour B K. 4 rows * Repeat stripe sequence * to * to 16 rows M.D.E. C.O.R. 000.

2 Colour A inc. 1 st. on each edge every 14 (16, 18) rows 3 times to 70 (78, 86) sts. K. to 44 (50, 56) rows. (Transfer pattern begins 4 (6, 8) rows after rib).

3 Cast off 7 (8, 9) sts. at beg. next 2 rows to 56 (62, 68) sts. C.O.R. 000.

4 Dec. 1 st. on each edge every 4th row, 4 times to 48 (54, 60) sts. K. to 16 rows.

5 K. 32 (34, 36) rows to shoulder.

6 Cast off 7 (8, 9) sts. at beg. next 2 rows then cast off 6 (7, 8) sts. at beg. next 2 rows. Thread up remaining 22 (24, 26) sts.

Front Neck

(As back to 5)

5 K. 22 (24, 26) rows to front neck. Cast off centre 12 (14, 16) sts. ** H.C.L. II (800 H.C.L. 1). Push left NS to E pos. On right front neck dec. 1 st. every alt. row 5 times to 22 (24, 26) sts.

6 Shoulders. As for back H.C.L. I. Repeat 5 and 6 from ** reversing all shapings for left front neck.

Sleeve

Ribber 1 Cast on 41 (45, 49) sts. in colour C. Make rib as tor back.

Single Bed M/Cs. As for back.

2 Colour A inc. 1 st. on each edge every 5th row 8 (9, 10) times to 57 (63, 69) sts. K. to 44 (50, 56) rows.

3 Cast off 7 (8, 9) sts. at beg. next 2 rows to 43 (47, 51) sts.

4 Dec 1 st. on each edge every 4th row 6 (7, 8) times to 31 (33, 35) sts. 24 (28, 32) rows.

5 Cast off 5 sts. at beg. next 4 rows to 11 (13, 15) sts. Cast off these sts.

Shoulder Neck Bands

Ribber. Colour C cast on 51 (57, 63) sts. T2/2. K. 4 rows Tubular. T3/3. colour B K. 1 row. Working 2NS in from each edge make buttonhole over 3NS miss next 2 (3, 4) NS. Make 2 more holes in same way (3 on each edge) K. 1 row. Colour C K. 2 rows. Trans. NS to MB.

Single Bed M/Cs.

C.O.B.H. 51 (57, 63) sts. in colour C. T5. K. 6 rows T7. K. 1 row T5. K. 2 rows. Colour B K. 1 row. Make buttonholes as for rib. K. 1 row. Colour C. K. 2 rows. M.D.E. With right

REPEAT STEPS 1 TO 8

35	■	■	■	■	■	■	■	→	u	A	
34								→	u	"	
33								→	u	"	
32			■					→	u	"	
31								→	u	"	
30			■					→	u	"	
29								→	u	"	
28	■							→	u	"	
27								→	u	"	
26	■		■		■		■	→	u	C	
25	■		■		■		■	→	u	A	
24								→	u	"	
23			■					→	u	"	
22								→	u	"	
21			■					→	u	"	
20								→	u	"	
19	■		■		■		■	→	u	B	
18	■		■		■		■	→	u	A	
17								→	u	"	
16	■							→	u	"	
15								→	u	"	
14								→	u	"	
13	■		■		■		■	→	u	"	
12	■		■		■		■	→	u	"	
11								→	u	"	
10								→	u	"	
9	■		■		■		■	→	u	C	
8	■		■		■		■	→	u	A	
7								→	u	"	
6								→	u	"	
5								→	u	"	
4								→	u	"	
3								→	u	"	
2								→	u	B	
1	■		■		■		■	→	u	A	
STEPS	1	2	3	4	5	6	7	8	L.C.	K.C.	COLOUR
	K.H. 588 MACHINE SLIDE DIAL 3 REVERSE KNOB A										

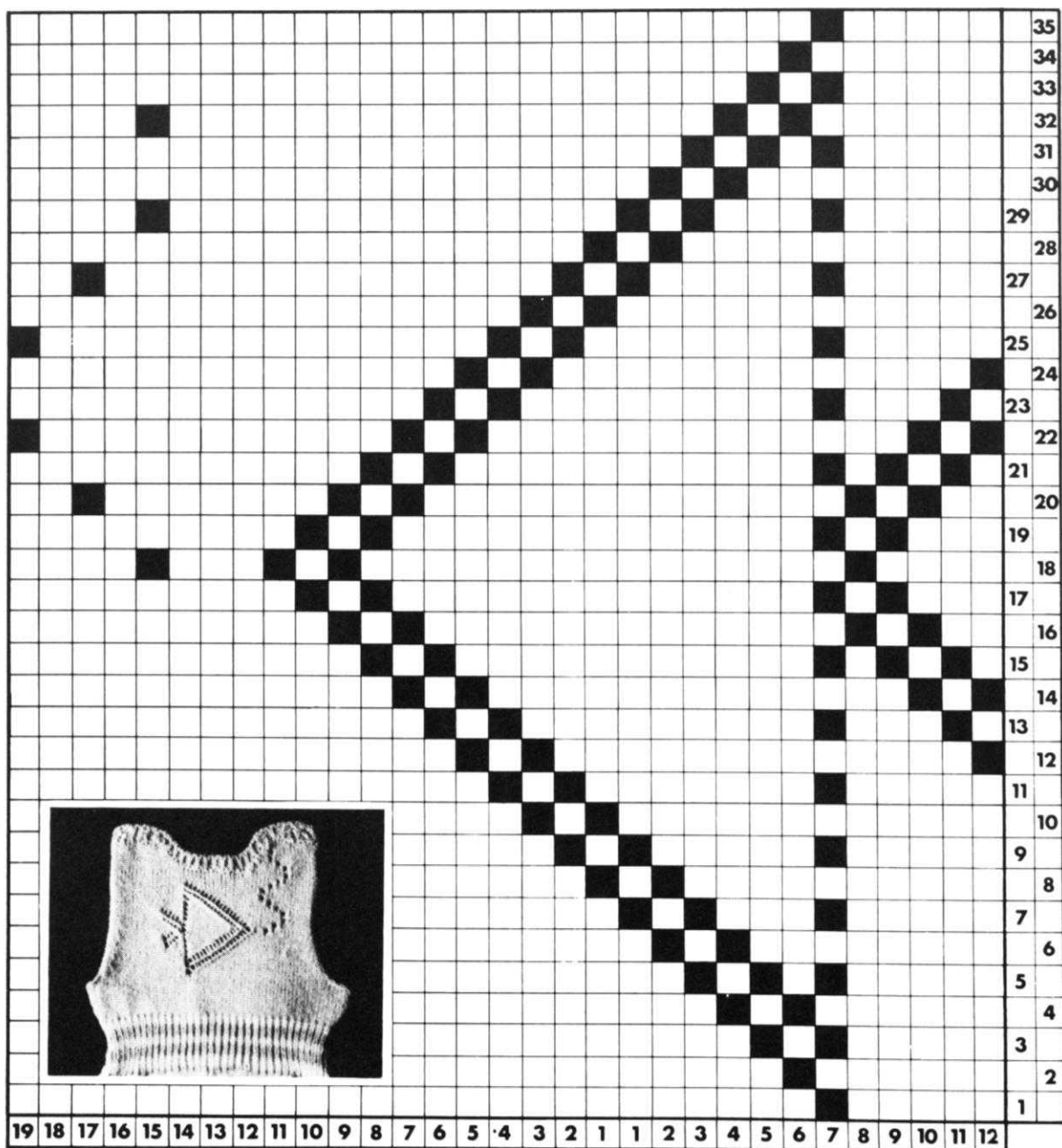

Centre 0



Jones

the knitting machine people

Jones Sewing Machine Co. Ltd.
BRITANNIA HOUSE,
964 HIGH ROAD, FINCHLEY, LONDON, N.12