

Studio

KNITTING MACHINE

"The Most Wanted Automatic Home Knitter"

NEWSLETTER

JULY/AUGUST, 1983

VOLUME 170



FROM THE DESK OF DAVE BRATZ

It appears that the summer knitting doldrums has pretty well set in. When you talk with people that tell you the temperature is a cool 96 degrees and about 90% humidity, it sure makes you feel so much better to be living in Washington State where we really crab if it reaches 90°. I guess it also makes it easier to understand why knitting slows down in most parts of the country more than in the Seattle area.

Last issue I had mentioned the weaving arm as a new item. We are happy to report they have arrived and should already be in your dealer or distributors' shops. If you haven't seen one of these automatic weaving arms in operation, you are in for a real treat. It makes weaving so simple, whether you use a heavy yarn or fine yarn, you wonder how you ever did it before. The suggested retail cost is \$69.95. Our first shipment is nearly sold out, so please be patient if you experience a little delay.

It would appear that this is the only major new item in the immediate future. I cannot help but reflect on the tremendous progress that has been made in the home knitting machine field since its early beginnings. It is also encouraging to see the home knitter being able to supplement and in some cases be their main source of income, through knitting for others or starting their own knitting business. I am all in favor of small business having a chance at making a profit in a highly competitive field.

Happy Knitting!!!!!!!!!!!!!!

AUTOMATIC WEAVING ARM AW-1

You will be freed from entanglement of yarns when you change the weaving yarn over to the other side of the Carriage.

This Automatic Weaving Arm changes the weaving yarn to the leading side of the Carriage when it passes over the edge of the fabric. You only move the Carriage smoothly across the needle bed as you knit stockinet stitches.

\$69.95

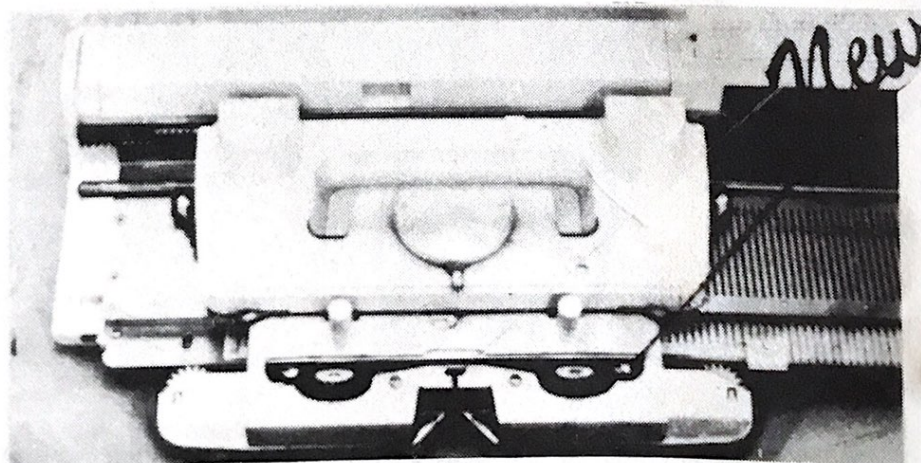

As we previously promised, this issue is devoted to the patterns our Studio dealers demonstrated at the Spring Seminar here in Seattle.

I. Hunt, our Studio dealer in Alderwood Manor, WA, designed the child's pullover which Dave Bratz's son, Davey, is modeling on our cover.

CHILD'S KNIT-IN RAGLAN

PULLOVER

Made on a Studio SK-370

Size 5-6

1 strand Softy - about 5 oz.

Tension - 5

Gauge - 9-1/2 sts. & 14 rows per
1 inch.

Finished measurements:

Chest	26"
Length	16-1/2"
Sleeve Length	11-1/2"



BACK: Cast on 125 sts. Rib tension 1 for 30 rows. Change sts. to main bed & inc. 1 st. = 126 sts. Knit Ten. 5 to row 148.

RAGLAN SHAPING: Counter zero. Levers to hold. Push 1 needle in hold in front of carriage each row to row 84. Take 42 sts. that remain for back neck off on waste yarn. Push 42 sts. to C position on left side. Knit 1 row main color & 10 rows waste yarn. Repeat for right side 42 sts.

FRONT: Follow pattern same as back to row 148. R.C.O. Repeat raglan shaping to row 52 for neck edge - as follows: put sts. in hold opposite 0 plus 5 sts. on other side of 0 - knit to neck edge (center). Put 1 st. in hold in front of carriage at neck edge. Knit across. Put 2 sts. in hold neck edge. Knit across. Put 1 st. in hold every row at neck edge 5 times. Put 1 st. every other row 5 times. Knit 3 rows & decrease with 2-prong tool. Knit 3 rows again & decrease. Knit 4 rows & decrease. Remember to maintain armhole shaping. Take raglan sts. off on 1 row main yarn & 10 rows waste yarn. Repeat from row 52 to shape other side of neck & raglan. Take raglan sts. off on 1 row main yarn & 10 rows waste. Take 36 center neck sts. off on 1 row main yarn & 10 rows waste yarn.

SLEEVES: Cast on 14 sts. on waste & knit 10 rows. Knit 1 row ravel cord. Levers to hold. Hang raglan sts. of front with neck to center of machine. Remove waste yarn & 1 row of main yarn (be careful not to lose wrap sts.) Hang raglan back sts. onto other side with neck to center. Remove waste yarn & 1 row of main yarn. Put raglan sts. in hold. Knit across center 14 sts. with main yarn & then wrap needle in front of carriage & tuck needle opposite carriage into C position each row until all needles are back into work. 84 rows. R.C.O - Decrease with 3-prong tool 1 st. each side every 8th row 14 times. 70 sts. remain. Knit to row 121, decrease 9 sts. evenly across row 61 sts. Knit 1 row & change sts. to rib (1 x 1) Rib to row 162 using Tension 1. Change carriages to circular knit. Knit Tension 5 with ravel cord & 10 rows with waste yarn. Take off machine.

NECK RIB: Pick up 42 sts. of back neck - 14 sts. top of sleeve, 9 sts. from neck edge - 36 sts. neck front - 9 sts. at other side of neck. ADD 14 sts. on waste yarn & 1 row ravel cord for other sleeve top. Pull out ravel cord of Finished sleeve top & take out front neck waste yarn & 1 row of main yarn (be careful not to lose wrap sts.) on neck. Knit 1 row.

(Continued)

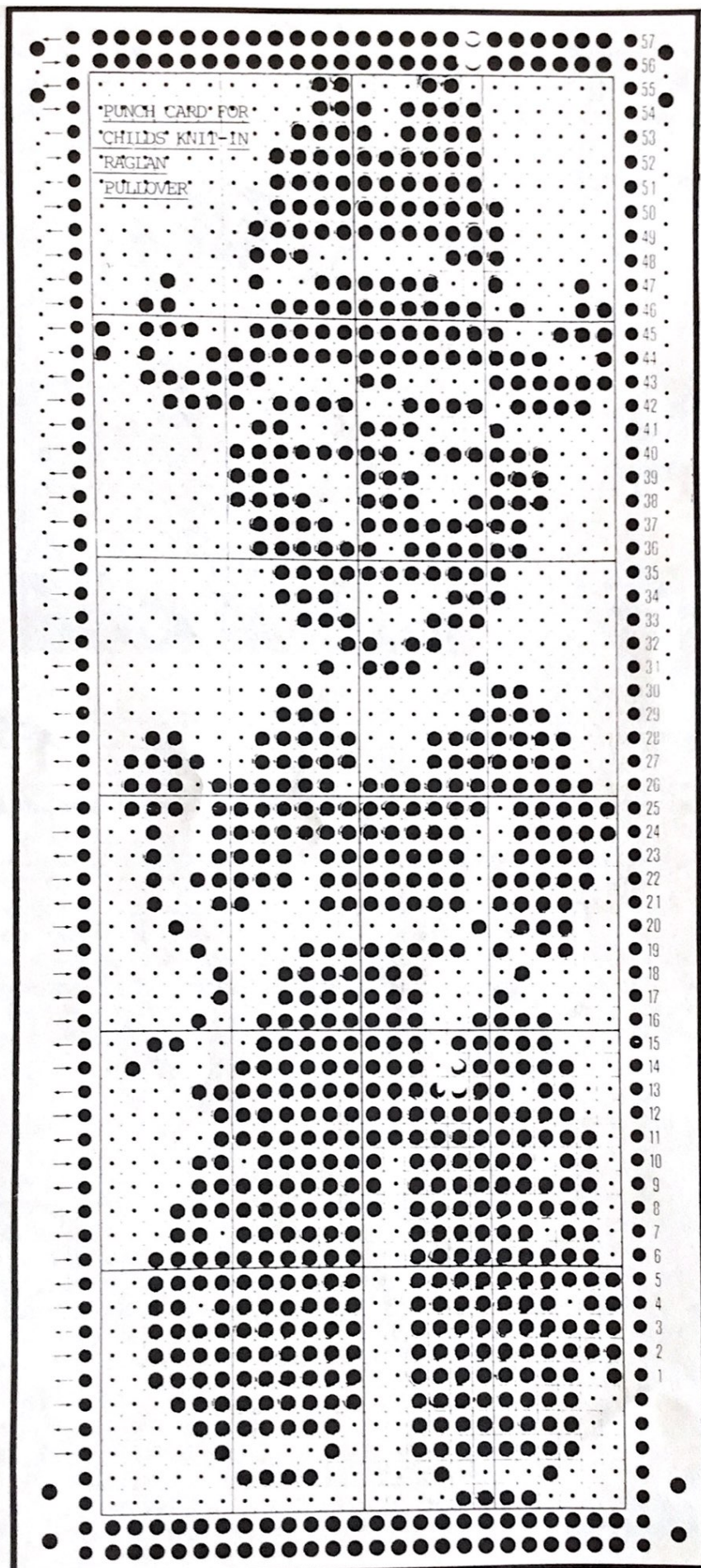

Child's Knit-in Raglan Pullover (Continued)

Ten. 5 - 124 sts. with main yarn. Change sts. to 1x1 rib. Rib neck band
30 rows Tension 1. Hang sts. back on main bed & knit 1 row ravel cord
10 rows waste yarn. Take off.

2nd SLEEVE - Hang 14 sts. of other sleeve top off waste yarn in center of machine. Hang sts. off waste yarn on raglan each side of the 14 sts., be careful not to twist garment. Unravel waste plus 1 row of main color. Now knit other sleeve in.

Finish sleeve cuffs: Weave neck sts. to inside of neck; sew side of neck rib and sew side seams.

COWBOY - Longate pattern. Card is marked where color changes. I started card on row 8.

Another pattern from Liz is this one for a

QUICK AND EASY SWEATER which Liz is wearing in the picture.

2 strands of Delaine Delsoft Yarn, about 2 cones

Sweater Measurements: Bust - 37"

Arm Length - 17" Shoulders - 13-3/4"

Length - 23"

Gauge - 8-1/2 sts. & 12 rows = 1 inch

Tension - No. 4

BACK - Cast on Tension 0 - 157 sts. Rib on Ten.

1 for 30 rows. Change sts. to main bed & inc.

sts. - 158 sts. Knit on tension 4 to row 186-
Row Counter to Zero.

ARMHOLE - At end of next 2 rows take off 9 sts. on a thread or holder. Dec. 1 st. each side of next 6 rows. Dec. 1 st. each side every other row 4 times. Dec. 1 st. each side of third row 1 time. You will have 118 sts. remaining to knit to row 84.

SHAPE SHOULDERS - Place all sts. opposite 0 plus 22 sts. on other side of 0 in hold - 37 sts. next to carriage in work.

Row 1 Knit to neck edge.

Row 2 Place 1 st. at neck edge in hold & 5 sts. at shoulder edge. Knit across.

Row 3 Place 5 sts. in hold in front of carriage & wrap yarn. 1 st. back & then up & down over needles to nearest st. in work. Knit across.

Row 4 Place 1 st. next to carriage & 5 sts. at shoulder edge in hold. Knit across.

Row 5 Place 5 sts. in hold at shoulder edge - wrap & knit across.

Row 6 Place 1 st. at neck edge & 5 sts. at shoulder edge in hold. Knit across.

Row 7 Place 4 sts. in hold, wrap & knit across.

Row 8 Place 1 st. at neck edge in hold. Push needles of shoulder back until the open latches touch yarn on needles, then knit across 33 sts. for shoulder.

Take off on 10 rows of waste yarn.

Shape other shoulder to correspond.

NT - Where cable pattern is worked mark needlebed with a soft lead pencil on sts. each side of 0 number: 6-7-8-9 11-12-13-14 38-39-40-41 43-44-45-46. Use 2 prong tools, take 6-7 on 1 tool & 8-9 on another tool
(Continued)



Quick and Easy Sweater (Continued)

off needles. Crossing tools replace 8-9 on first, then 6-7 on needles 11-12 first, then 13-14. Cable over other sets in same manner every 10 rows. Knit in pattern to row 186.

ARMHOLES - Same as for back.

NECK - Shape front neck at row 48. Place all sts. in hold opposite carriage, place 6 sts. in hold on carriage side of 0, knit across. Place 2 sts. in front of carriage in hold, wrap and knit to shoulder edge. Place 2 sts. in hold at neck edge, knit across to neck edge.

Place 1 st. every row in hold at neck edge for 9 rows. Place 1 st. in hold every other row at neck edge 3 times. Decrease with 2 prong tool every third row 2 times. Decrease 1 st. every fourth row 1 time. Decrease 1 st. every 5th row 1 time. Knit to row 84, ending at neck edge - Shape shoulder, 5 sts. in hold every row 5 times - 4 sts. in hold 2 times (33 sts.) Knit 1 row across 33 sts. and take off on 10 rows waste yarn.

Shape other side of neck to correspond.

SLEEVE - Cast on 69 sts. tension 0 for rib, then rib on tension 1 for 40 rows. Change to main bed and increase 15 sts. across row evenly. You will have 84 sts. Increase 1 st. each side every 8 rows 6 times. Increase 1 st. each side every 9 rows 12 times. You will have 204 rows and 120 sts. (Do cable pattern over center 9 sts.) SHORT ROW CAP OF SLEEVE: 8 sts. opposite carriage, knit across. 1 st. in front of carriage and 9 sts. opposite, knit across. Put 1 st. in hold at beginning of row 14 times. 1 st. each side every row 24 times. 1 st. at beginning 14 times. Push 1 st. at beginning and 2 sts. opposite in hold, knit across. Push 1 st. at beginning and 3 sts. opposite in hold, knit across. You have 20 sts. left in center; take off on garter bar. MAKE two sleeves.

Join 1 shoulder seam placing 1 side with right side facing you behind latches on needles and place corresponding side with wrong side facing you over same needles in latches. Pull sts. through and bind off.

NECK RIB - Cast on 159 sts. with tension 6, knit 6 rows; knit 6 rows on each of the following tensions: 5.2-5.1-5..4.2-4.1-4..3.2-3.1-3 = 60 rows. Take off on garter bar. With right side of garment facing you hang 54 sts. of back neck; 20 sts. each side of neck - 44 center of neck; total of 138 sts. plus 21 sts. for ease = 159 sts.

PLACE STS. BEHIND latches:

Hang sts. across back neck 1 to 1 basis; across front neck have every 4th needle double.

Now place sts. from garter bar on needles in latches and pull through and do a double bind off.

DOUBLE BIND OFF - Hang claw weight on edge of work to swing free. With extra yarn wrap first needle under and around needle, pull through - wrap same needle and pull through again. Transfer to next needle - do this across all needles.

Join other shoulder seam. Hang sleeve with front side facing you. 120 sts. Place in behind latches. Put sleeve on in latches using claw weight so it does not curl up and off needles. Pull sts. through and Double Bind Off

Do same with other sleeve.

* * * *

The following patterns were demonstrated by Gini Woodward, our
audio dealer at Bonners Ferry, Idaho.

IRISH FISHERMAN KNIT PILLOW

Made on a Studio Knitting Machine

Materials:

3 oz. Orlon 3/15 or Softy
(2 strands)
12 inch pillow form

Pitch lever H

Tension 6

- (1) Cast on every needle each
bed - tubular cast on.
(116 st. each bed)
- (2) Transfer needles according
to needle set-up.
- (3) Follow chart to make
pattern, transferring and
crossing stitches.

Pattern #1 is double moss
4 row repeat

Pattern #2 is cable - 10 row repeat

Pattern #3 is tree of life - 10 row repeat

Pattern #4 is modified honeycomb - 20 row repeat

Pattern #5 is diamond with popcorn stitches
40 row repeat

ALL CHANGES

MADE WHEN

CARRIAGE IS ON

RIGHT.

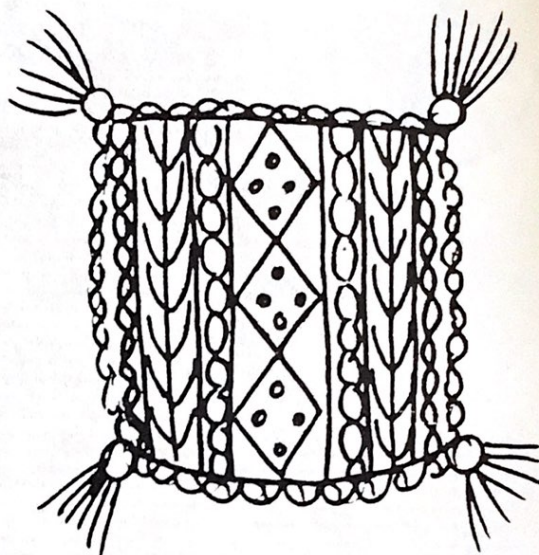

Popcorn Stitch

Knit with a separate strand of yarn. Start and end with carriage
on the right side.

1. Pick up 2 stitches from the ribber bed and manually knit
(e wrap before manually knitting).
2. Wrap and manually knit 1 more stitch from the left side
and the original 2 stitches (3 stitches total).
3. Repeat Row 2 but pick the 4th stitch up from the right side.
4. Knit back through all 4 stitches.
5. Decrease 1 stitch each side - back to original 2 stitches.
6. Manually knit and transfer back to ribber bed. Bring 2
needles up to C position, break yarn and drop ends between
beds.

(4) Repeat diamond pattern 3 times to row 120.

(5) Transfer all stitches to main bed.

(6) Link off.

Back:

- (1) Cast on 80 stitches on main bed.
- (2) Insert card #3. Knit 2 rows in stockinette.
- (3) Set to Tuck. Release card.
- (4) Knit 160 rows in pattern.
- (5) Knit 2 rows in stockinette.

FINISHING - Stitch back and front together over pillow form.
Make twisted cord and stitch over outer edges to trim, making
bosses on each corner.

FISHERMAN KNIT
PILLOW SET-UP

Made on a Studio
Knitting Machine

Designed by Gini
Woodward

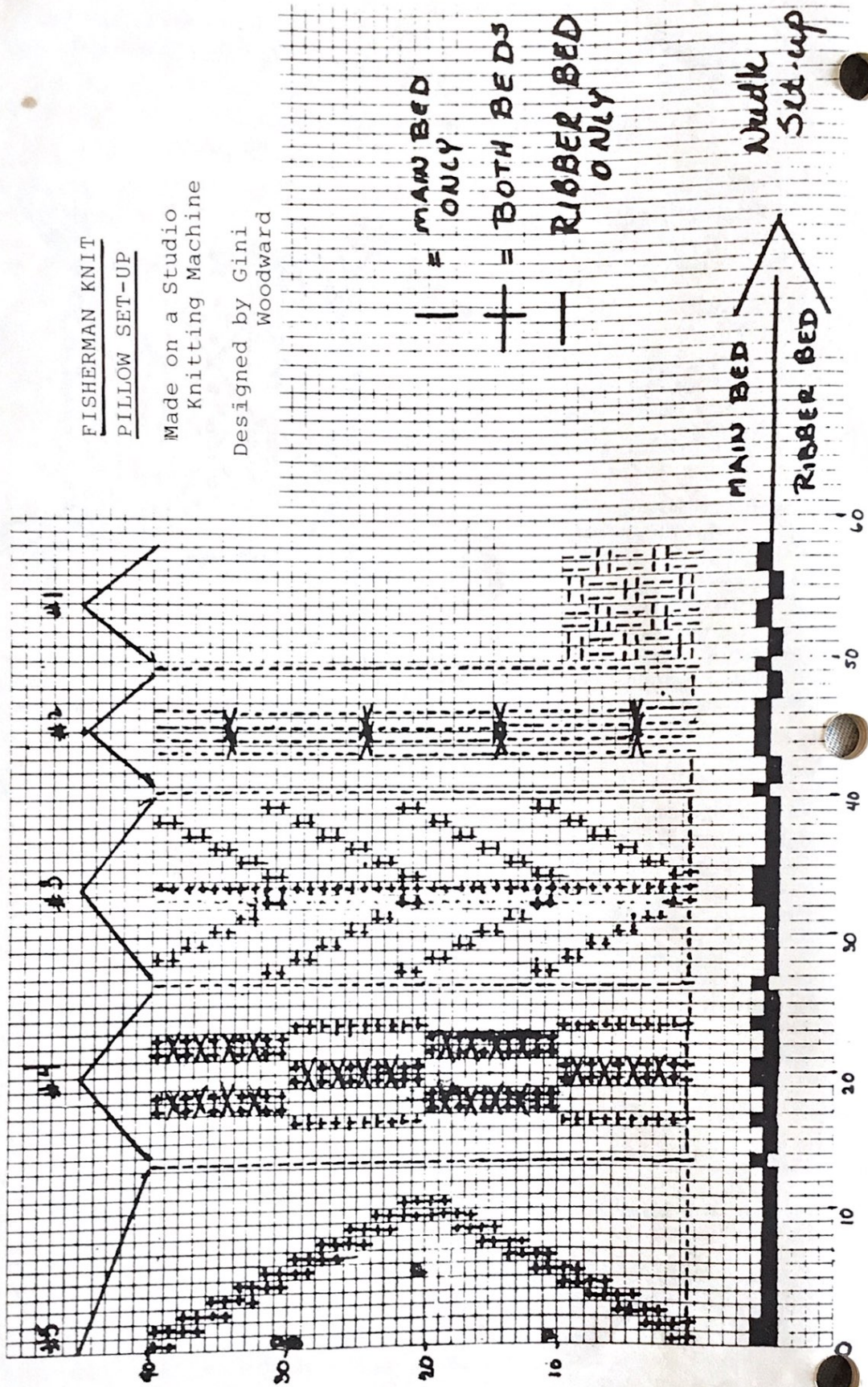

NORDIC CHRISTMAS STOCKING

Made on a Studio Knitting Machine.

Designed by Gini Woodward

3 oz. Softy 2/15 (use 2 strands) or 3/11

Red (R), Green (G) and White (W)

Tension 8

With the above three colors there are 6 different ways to knit this pattern. Follow the chart for each combination and have fun knitting!!!!

Punch one card for each of the two designs (A & B).

- 1) Cast on 96 sts. with the first color from your chart. Insert pattern A & lock on Row 1. Knit 34 rows. Reset R.C. to "O".
- 2) Set up machine for Fairisle. Follow chart for color combination. Knit.
- 3) Hang up hem after Row 30.
- 4) Continue in pattern to Row 43.
- 5) Change to Pattern B - all-over pattern card. Lock on Row 1.
- 6) Knit 2 rows plain according to chart color.
- 7) Set for Fairisle and knit until 10 repeats of design are complete.
- 8) Lock card. Set to stockinette. Remove 2 colors and set aside. Place 3rd color in feeder 1.
- 9) Shape heel (refer to sock lesson)
- 10) Remove color in feeder 1 and replace two colors as before. Reset machine for Fairisle. Be sure to return all needles to "B" position before starting pattern. Knit 5 repeats of pattern.
- 11) Shape toe as heel in same color and remove on waste yarn.

Finishing: Kitchener stitch toe & seam side seam. Steam flat. Make a twisted cord about 18" long. Cut in half, knot all 4 ends. Fold one piece in half and make a knot to form a loop about 1½" from top. Before tightening, insert the other cord through the knot & with 2nd cord tie a bow over the knot. Fasten 2 bells at the top & back of stocking. Attach the cords over the top of the bells. Twist the ends of the original cord slightly & secure to sock close to the bottom of cords. Now that you are thoroughly confused, look closely at the illustration & see if it helps!!

VARIATION	1	2	3	4	5	6
Cast on w/	W	G	R	G	R	W
Row 1-2	W/G	G/R	R/G	G/W	R/W	W/R
3-4	W	G	R	G	R	W
5-9	W/R	G/W	R/W	G/R	R/G	W/G
10-11	W	G	R	G	R	W
12-13	W/G	G/R	R/G	G/W	R/W	W/R
14-15	R	W	W	R	G	G
16-28	R/G	W/R	W/G	R/W	G/W	G/R
29-30	R	W	W	R	G	G
Hang hem						
31-32	W/G	G/R	R/G	G/W	R/W	W/R
33-34	W	G	R	G	R	W
35-39	W/R	G/W	R/W	G/R	R/G	W/G
40-41	W	G	R	G	R	W
42-43	W/G	G/R	R/G	G/W	R/W	W/R
44-45	G	R	G	W	W	R
Leg & foot	G/R	R/W	G/W	W/R	W/G	R/G
Heel	W	G	R	G	R	W



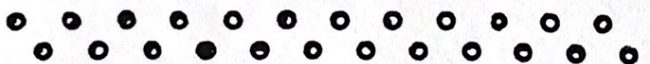
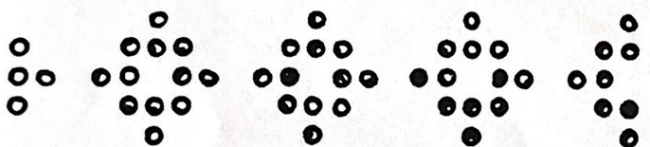
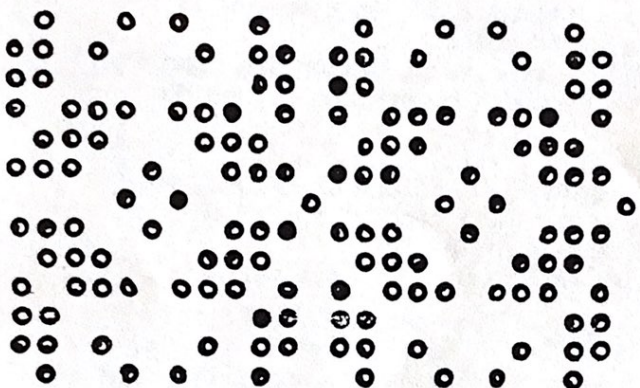
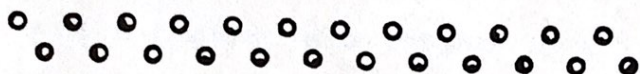
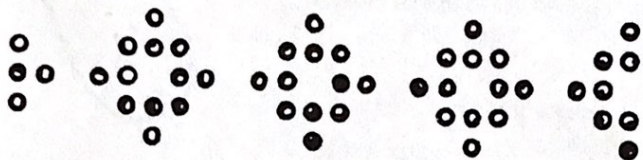

Pattern 'A'

NORDIC CHRISTMAS

STOCKING

Punch Cards

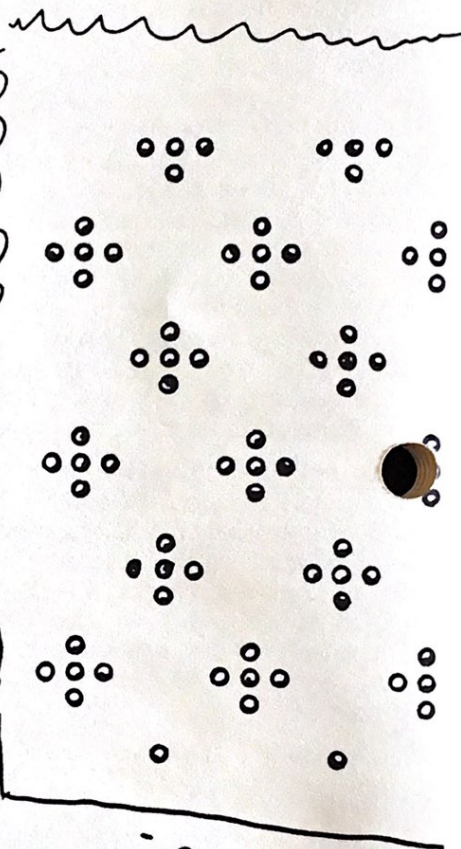

Pattern 'B'

MITTENS

Designed by Gini Woodward. Made on a Studio.

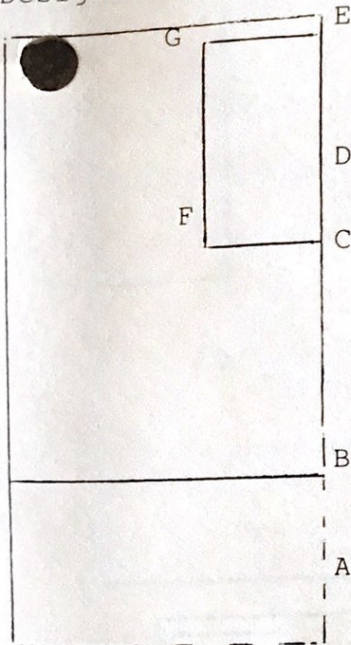

E Mittens can be knit in any pattern stitch or yarn once the desired size is determined from contour pattern. Trace appropriate size onto the contour paper. Make a swatch in the yarn and stitch desired. Measure the swatch. Set up the contour. Insert the paper into the contour device.

A. Cast on according to the contour & rib or mock rib the desired length.

B. Knit in the desired pattern over all sts. to C (thumb)

C. 1. Remove yarn from carriage and put to the side.

2. Bring all needles except the thumb sts. on the side opposite the carriage to D position.

3. If knitting in pattern lock card & set cam to stock.

4. Turn off contour. 5. Russell levers to 1.

6. Thread waste yarn into carriage. Bring end of waste yarn over the top of the D position needles & hold down in between the 1st & 2nd D position

needles closest to the thumb sts. & then back up over the rest of the D position needles to the carriage.

7. Knit 10 rows waste yarn ending on the same side you started.

8. Break the waste yarn & tuck down out of the way. 9. Turn contour on. (Unlock card & change to pattern st. if knitting in pattern).

10. Russell levers to 11. (If in pattern st., you must return needles to B position with a transfer tool.) 11. Rethread main yarn(s).

D. Knit all stitches to E. Turn off contour.

E. 1. If knitting in pattern it is suggested that you knit the top of the mitten & the thumb in stockinette. Lock the card & remove the second yarn, set the cam lever to stock.

2. Bring 1/2 of the needles on the side opposite the carriage to D position.

3. Russell levers on 1.

4. Bring one needle on the carriage side to D position.

5. Knit across.

6. Repeat steps 4-5 until 1/3 of the half stitches remain in work.

7. Take the yarn and wrap under the last needle brought to D position on the carriage side and back over the top of the other D position needles to the carriage. Push wrapped needle to C position.

8. Knit across.

9. Repeat steps 7-8 until all the half stitches are back in work (B position).

10. Remove stitches on waste yarn.

F. Thumb...If desired press waste yarn stitches to set. Return contour to F.

1. Cut waste yarn rows in half so you can spread thumb space open and top and bottom of waste yarn form a straight line.

2. Hang both waste yarns on the machine adding one stitch in the middle to give room and prevent a hole.

3. Knit to G last row a looser tension.

G. Take stitches off with double-ended transfer tool and pull up tight.

FINISHING: Kitchener stitch top, stitch seams, block.

REVERSE SHAPING FOR THE SECOND MITTEN.

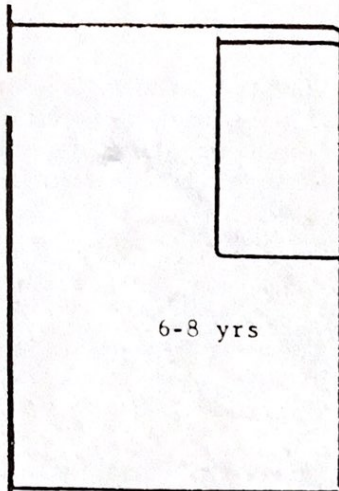

6-8 yrs

MITTENS

Transfer
to contour
paper and
knit!!!

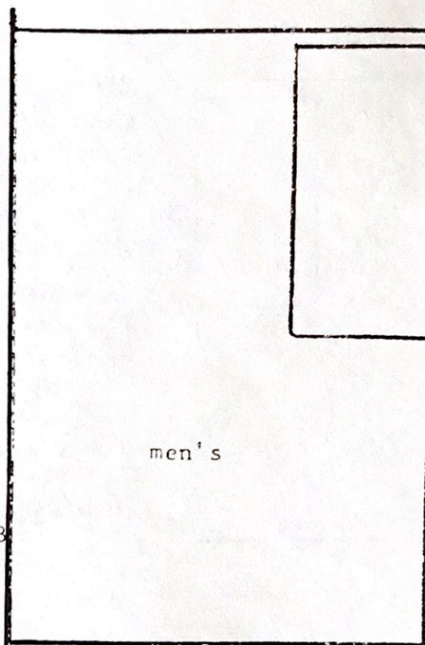

men's

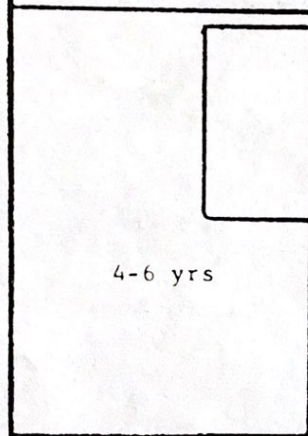

4-6 yrs

NOTE: ADD RIB
OR MOCK RIB
IN DESIRED
LENGTH TO
BOTTOM.

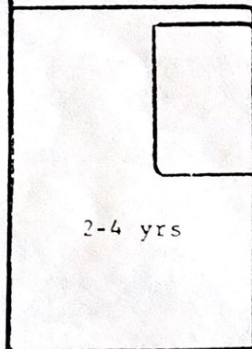

2-4 yrs

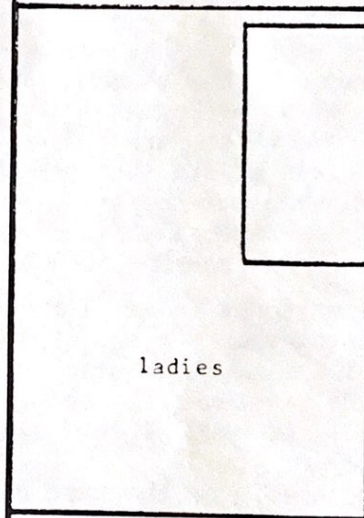
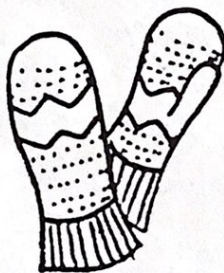

ladies

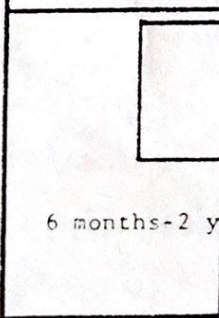

6 months-2 yrs.

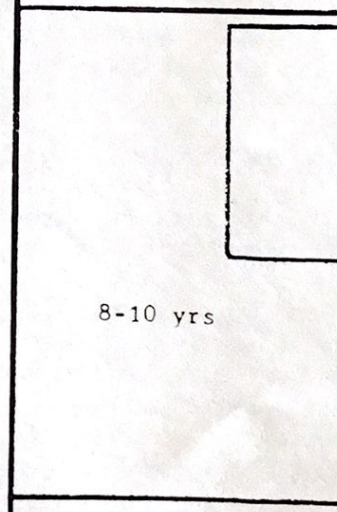

8-10 yrs

HELMET SKI HAT

Made on a Studio Knitting Machine

4 oz. sport weight wool

E cast on 146 sts. (Tension 7) -
Junior
146 sts. (Tension 8) -
Medium
146 sts. (Tension 9) -
Ex-large

- (1) Knit 34 rows in stockinette.
Turn off row counter.
- (2) Put all needles except #24 -
#60 (36 needles) on right side
of "0" into "D" position.
- (3) Partial knit on these needles
as though to shape a heel,
down to 4 needles and back out.
When all back in work, put
these needles to D position.



On left side of "0" return needles #24 - #60 (36 needles)
to "C" position. Shape second earflap in same manner as
first.

- (5) Start with row counter on 0. Insert pattern card and
lock.
- (6) Knit 4 rows. Start pattern and knit to approximately
Row 34.
- (7) Hang hem. The important thing is to hang the hem so it is
slightly shorter than outside of hat. Depending on
circumstances this could be more or less than 34 rows.
- (8) Continue knitting in pattern to row 90.
- (9) Transfer every other needle to next needle and put empty
needles to A position.
- (10) Knit 4 rows on every other needle.
- (11) Thread yarn through stitches to remove from machine and
pull up tight.

Designed by Gini Woodward

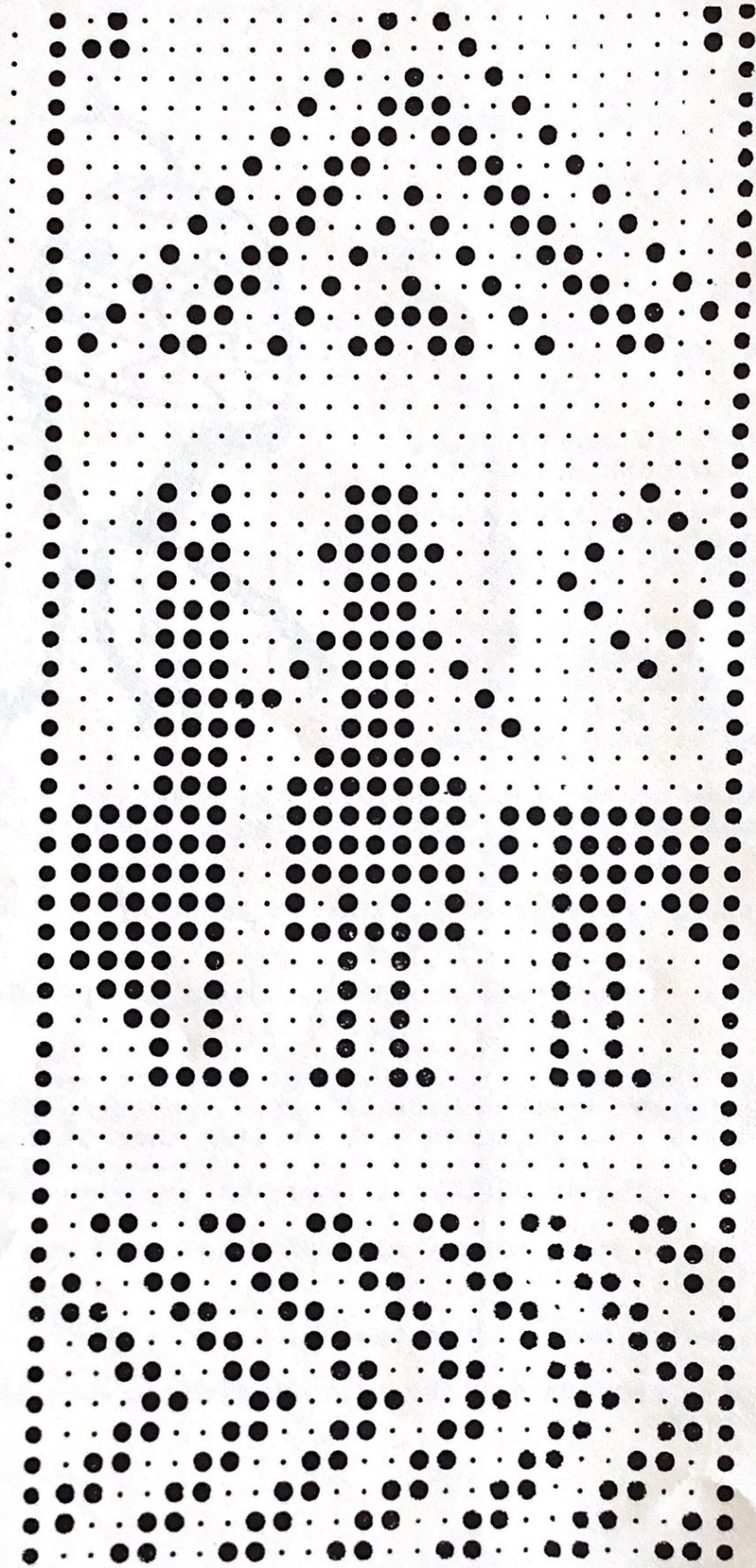

HELMET
SKI HAT
PUNCH
CARD

WE NEED YOUR ORIGINAL PATTERNS

"Newsletter" is your publication. Help support it by submitting your original patterns and helpful hints, so other home knitters can learn from your experience. We would like to urge all of you with older machines to share your favorite originals with our other readers. Many of our readers write in requesting simple, beginner patterns. You will receive a gift of yarn for any original pattern or hint that is printed. When sending in your patterns, be sure to include the size of the garment and the knitting gauge (number of stitches and rows per inch) - this is most important - and the knitting machine for which your particular pattern was designed. It also helps if you know approximately how much yarn your pattern takes. Please check and recheck your patterns for errors and type or print clearly. We do not have time to knit each pattern sent in, so cannot check for mistakes. It also helps if you do not abbreviate, as many of your terms are unfamiliar to us and to other readers. A black and white snapshot and/or brief description of your garment will make it easier to visualize by other readers. A gift of yarn will be sent for snapshots (black and white) printed with the patterns.

There is a wonderful opportunity awaiting you to become a STUDIO Knitting Machine and yarn dealer. Good money can be made in your spare time with only a small investment. We are interested in contacting men and women who would like to become a part of our growing group of STUDIO dealers throughout the United States. Our assistance and guidance can make this a very profitable venture for you, and our only requirements are that you know how to operate a knitting machine and that you have space available in which to set up your STUDIO shop, either in your home or place of business. You will find this a fascinating business which affords you the opportunity to become acquainted with new and interesting people. Contact Mr. David Bratz, Manager, STUDIO Yarn Farms, Inc., P.O. Box 46017, Seattle, WA 98146.

If you are planning to move soon, let us know both your old and new addresses, complete with zip codes. We cannot change your address without this information.

Patterns submitted and published in this "Newsletter" are submitted by individuals and are purported to be original patterns.

CANADIAN SUBSCRIBERS - Please remember, when sending in your subscription, all checks and money orders from Canada must be marked "Payable in U.S. Funds".

Please Note - We always notify you when your subscription expires. Your last issue is stamped across the Subscription Order Blank on the back page in red, "Your subscription expires with this issue". This issue is then mailed to you in an envelope and sent by first class mail. If you miss an issue, without having received this notification, please let us know, because it means that your mail isn't reaching you, and we will send you another copy. All the "Newsletters" are mailed out, altogether, just as soon as the mailer receives them from the printer.